

# FOLLOWING MEUSE RIVER LINES & MOUVEMENTS

## for a Paradigm Shift



...from defensive landscape to liquid one

...learning from lands' Ground Zero  
to design new River Lines  
for play and deal  
with

*inst-ability & un-certainty*



MAASTRICHT



VISÉ



# Meuse river...became a channel

A long, straight & monotonous waterline that cuts the opened fields as a glittering sword!

## Meuse and Landscape changed

- boundaries became smooth
- course became linear and smooth too
- islands disappeared
- water and land lost their capricious and dynamics characters giving sites and cities roughness, materiality and identity.

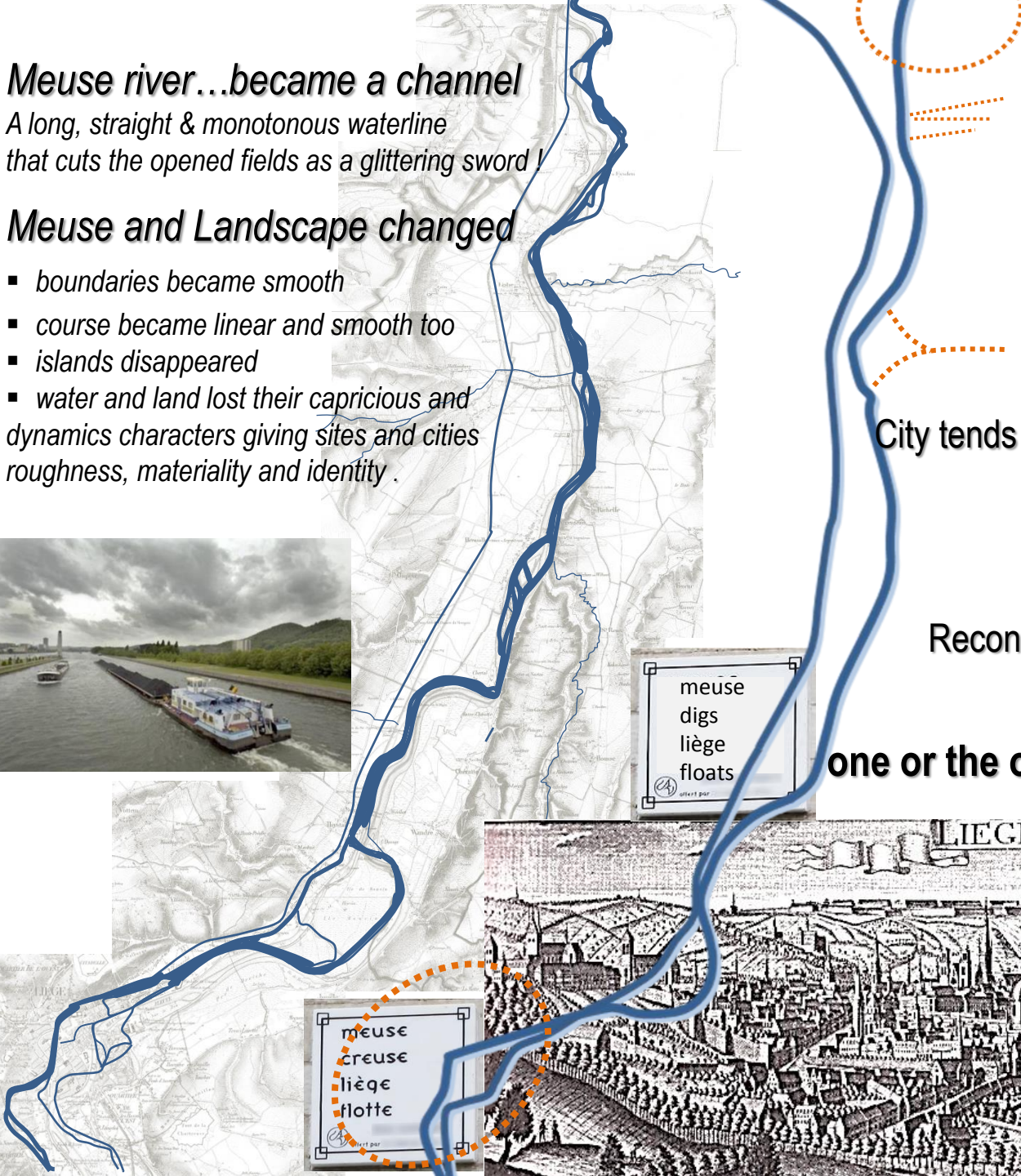

City tends to enchain the indocile flow of water;  
 River tends to break the rigidity,  
 to move and modify itself,  
 to make its relationship with the city  
 undefined and inconstant.

Reconciling the indocile mobility of the river  
 with the geometry of urban spaces  
 is not an easy operation:  
**one or the other inevitably tends to prevail**

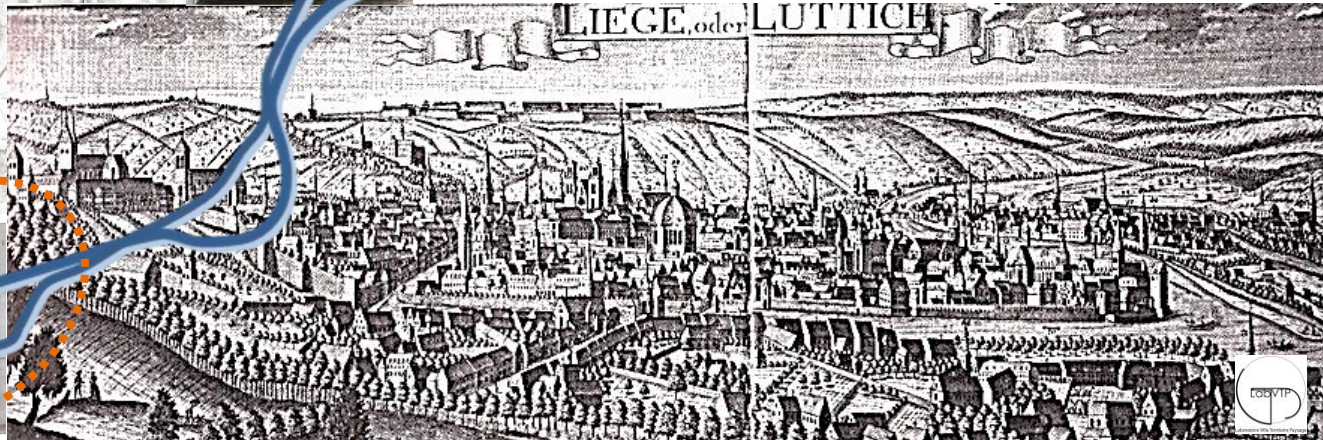

meuse  
 creuse  
 liège  
 flotte

meuse  
 digs  
 liège  
 floats







to the CITY-CORRIDOR  
for  
Circulation / Navigation



...from the WATER-CITY  
and PROMENADE

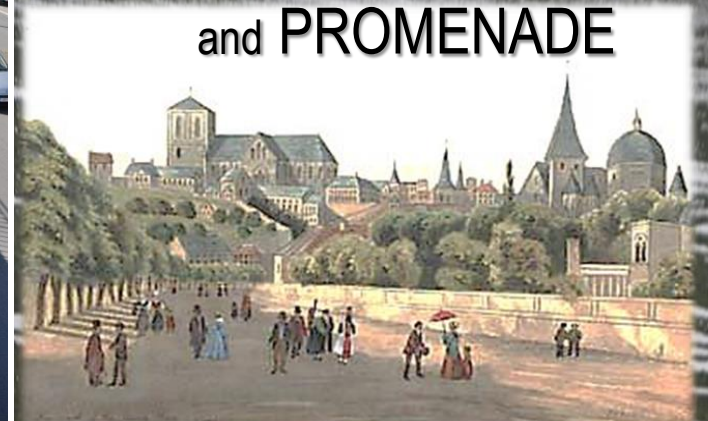



# MEUSE/MAAS River at the centre...

*Meuse river north* rolls in me as through Liège  
its name of laments and mists  
figure of thought this intuition of time and space  
Solution of brackish waters that the surface blinds  
to the bridge dam....

**Meuse fleuve nord** roule en moi comme à travers Liège  
son nom de plaintes et de brumes  
figure de la pensée cette intuition du temps et de l'espace  
Solution des eaux saumâtres que la surface aveugle  
jusqu'au pont barrage....  
[...]

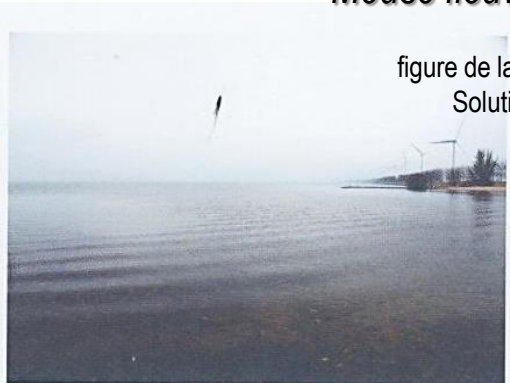

et de la **Meuse fleuve nord**  
j'ai vu la source et l'embouchure  
je connais chaque arpent du bassin versant  
j'ai bu la source aux noms de dieux improvisés  
j'ai navigué sur les hauts-fonds de l'estuaire  
[...]



j'ai compris que chaque fleuve dessine l'esprit  
ce nomade pareil à la **Meuse fleuve nord**  
étirant en épreuves les strates de conscience  
un tissu cicatriciel et fluide  
[...]

je n'ai pu concevoir  
ces lignes longtemps reportées  
ces lignes d'année en année refoulées  
sans l'ornement touristique  
de clichés photographiques  
pris à hauteurs d'homme  
[...]



l'un l'autre fusionnent en surimpression  
accumulés dans la compression des reliefs  
que j'ai érodés à force d'y fuir  
sans un mot sans un mouvement  
immobile en proie aux traits qui m'exhaussaient

Serge DELAIVE 2014



Charlotte DELOBBE

observe from the inside  
touch, experiment  
let the water fluctuate  
give it new room

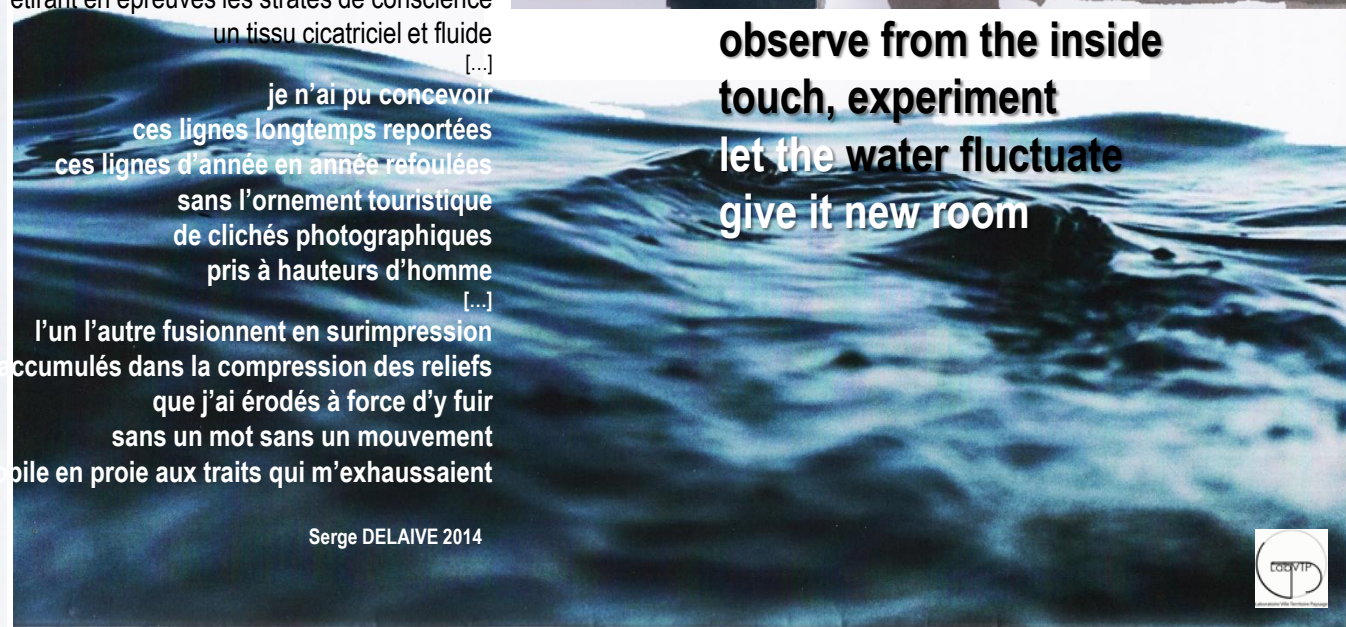



# MEUSE/MAAS River at the centre...

Shift the paradigm:

Canal Albert, the main road

Meuse/Maas, an opportunity for new water landscapes

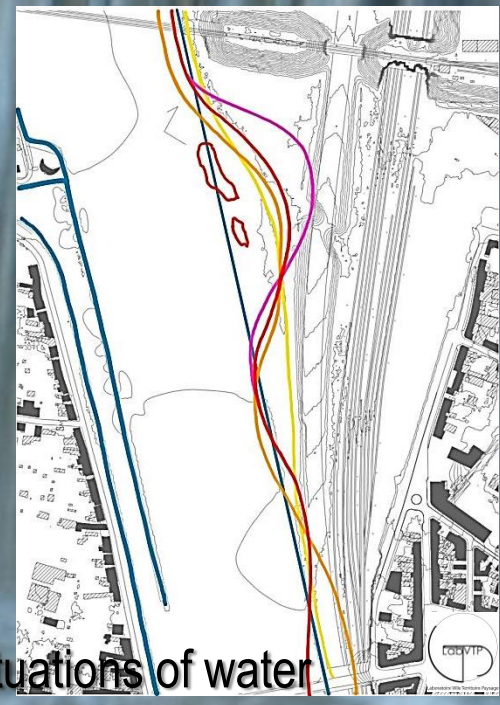
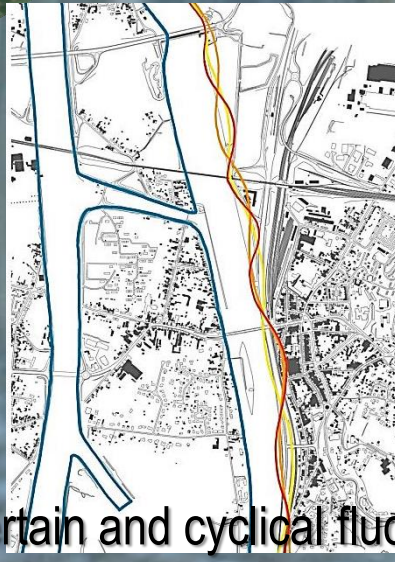
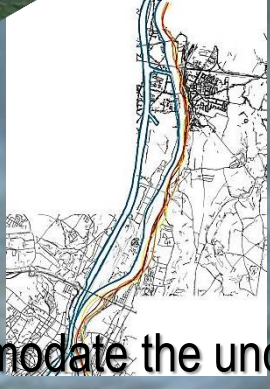
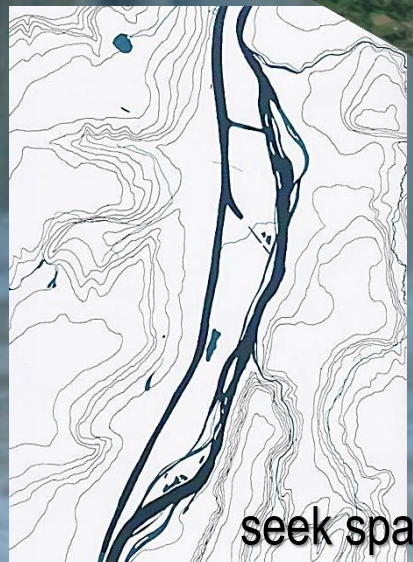
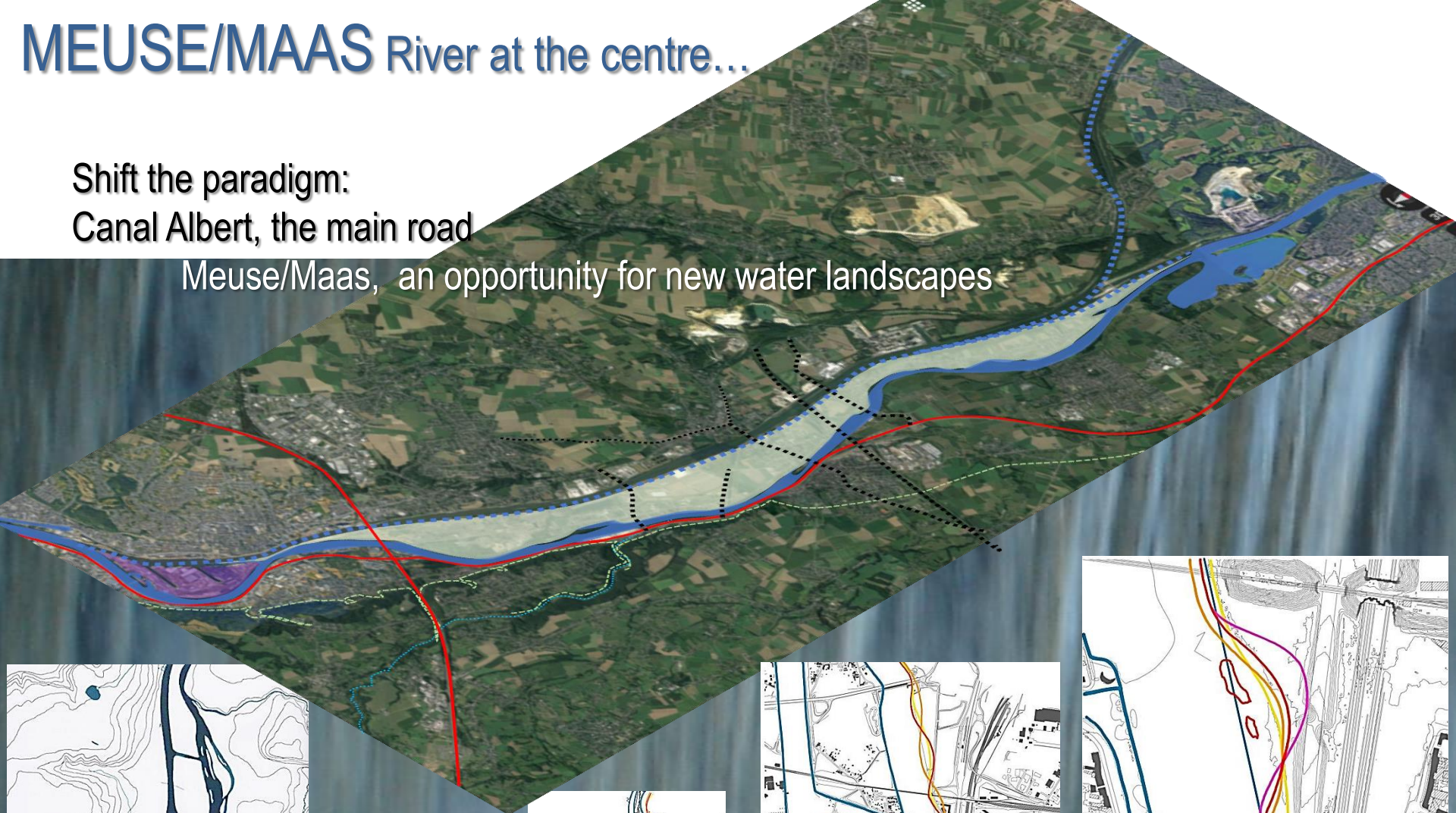

seek spaces to accommodate the uncertain and cyclical fluctuations of water





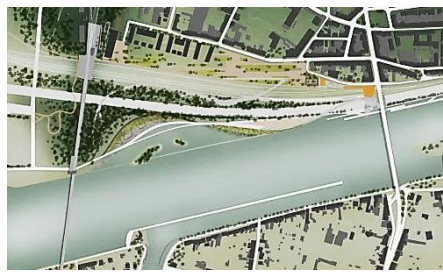

river

beaches



...the Meuse at the centre

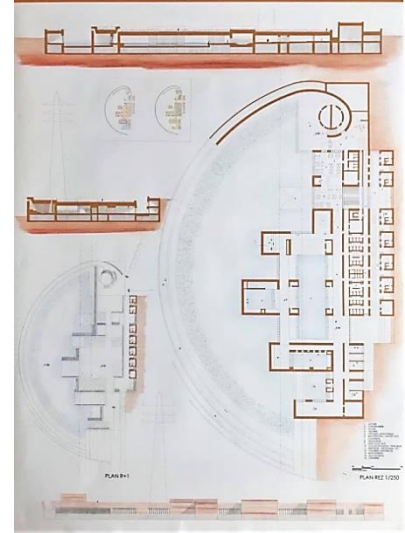

Ch: DELOBBE

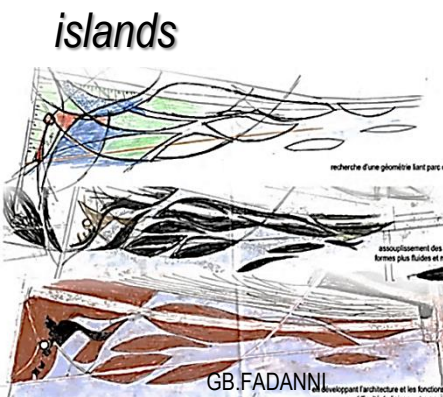

islands

recherche d'une géométrie forte parc et piscine

aménagement des courtes, formes plus fluides et naturelles

GB.FADANNI

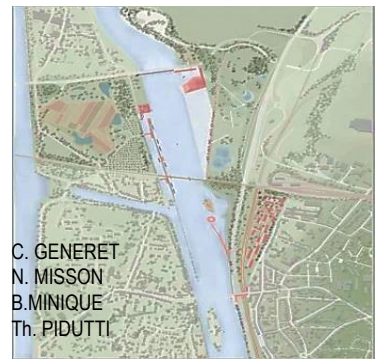

C. GENERET  
N. MISSON  
B. MINIQUE  
Th. PIDUTTI

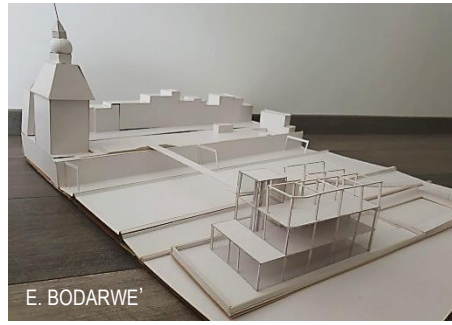

E. BODARWE'

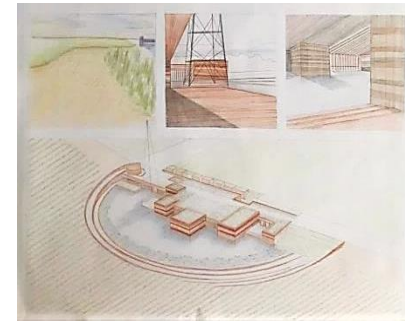

floating spaces & ground depression opportunities



designing with lines of water & infrastructures

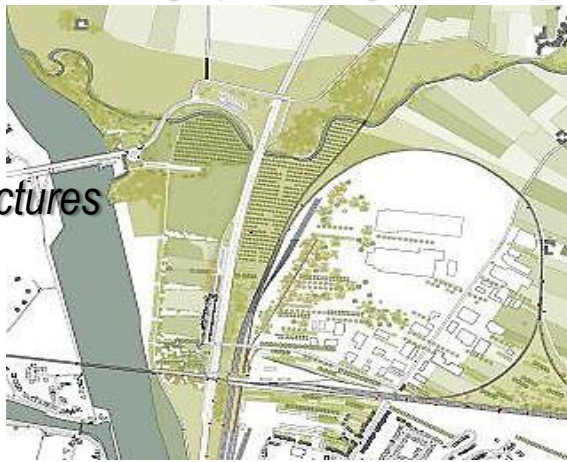

Th.PIDUTTI

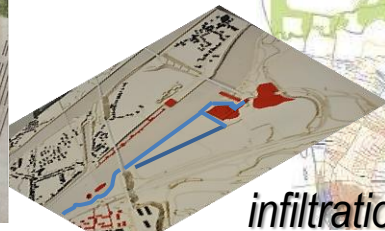

infiltration lines

A. HUBERT



A. GUERING





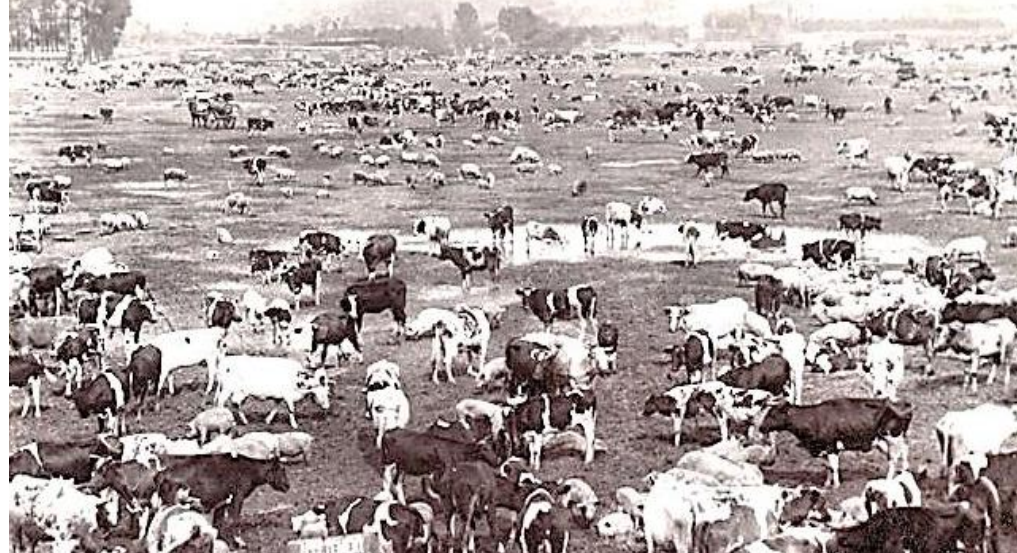
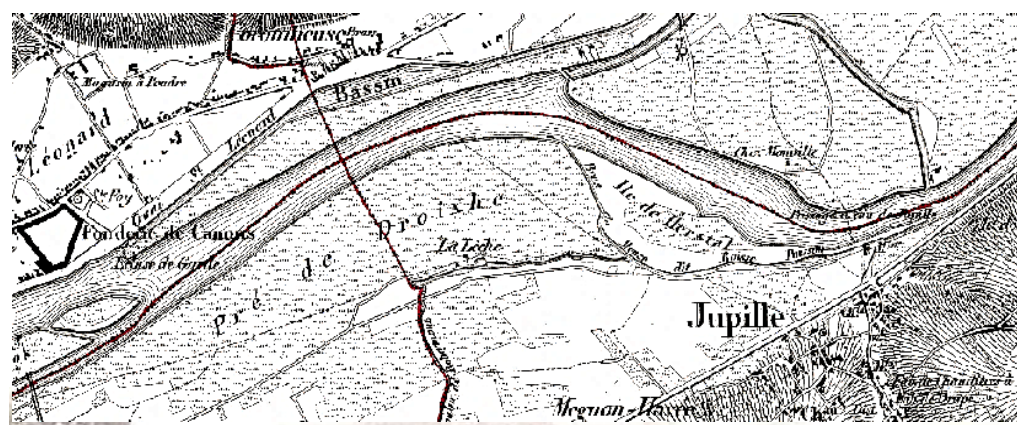

RIVE GAUCHE.

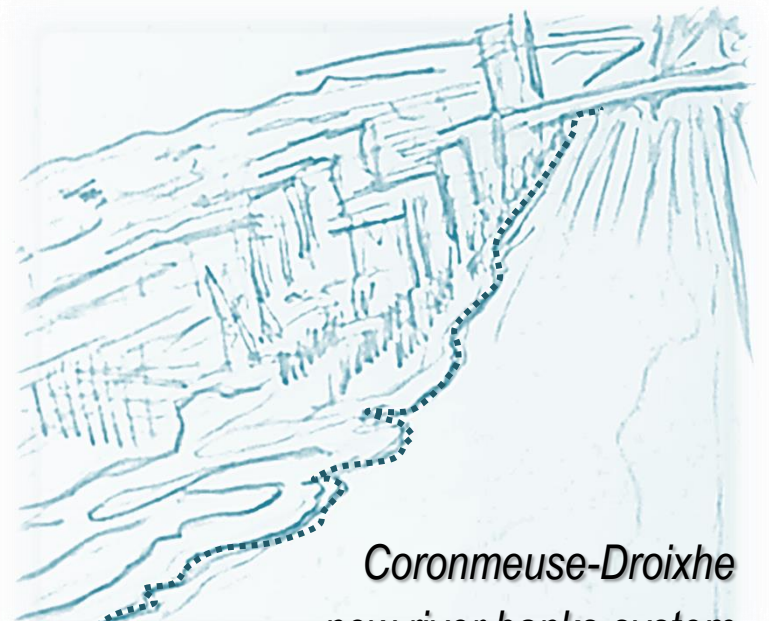
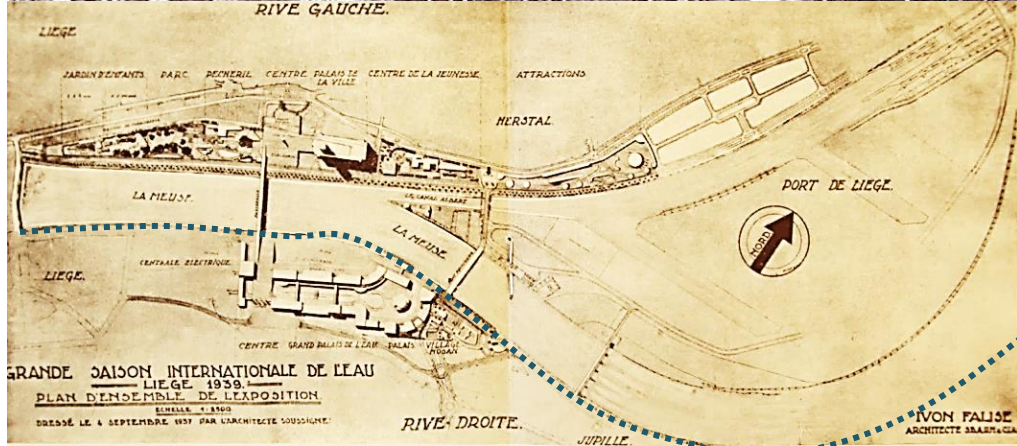

*Coronmeuse-Droixhe  
new river banks system*

opportunities for  
flexible projects,  
new fluctuations  
in the river's waters,  
restore the land's variation and porosity

*...to enter in Liège  
by crossing the hybrid places of a  
POREOUS & LACUSTRATED CITY  
in learning from wetlands*



## COMMENTS

Is the planning approach ready to:

- give space to the water ?
- follow water infiltration-lines ?
- consider ground infiltration
- think to the underground as a place in movement ?
- think the time of flow ?
- think water space as a place to live IN...and not ON?





merci  
thank you  
dank u  
danke

