



Agrégation-dispersion-empilement-
monument continu

Atelier d'architecture, 2016-2017, AAMMX

“When we, as architects, look at the architecture of the past, we all, I believe, try to penetrate the secret. (...) We are concerned with criteria and processes: with the how, before all else. It is this, which is peculiar in our observation: we look in order to learn how it is done. The first thing we learn, often at our own expense, is that this secret does not belong to form in itself”.

Giorgio Grassi, 1983



Le Corbusier, Unité d'habitation, Briey-en-Forêt, 1959

Open aesthetic

*« The open form in Architecture – the Art of the great Number.
The open form is opposed to the Charte d’Athènes principles,
which is a closed form, an attempt to define for once and for
all ».*

Oskar Hansen, 1959

Préoccupations structuralistes

« The focus on cells, connections and relationships correspond to a structuralist concern ».

Jacques Lucan, 2009

« En premier lieu, une structure offre un caractère de système. Elle consiste en éléments tels qu'une modification de l'un d'eux entraîne une modification des autres »

Claude-Levi Strauss, 1948

Metaphor as design Generator

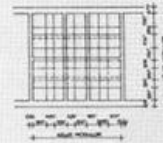
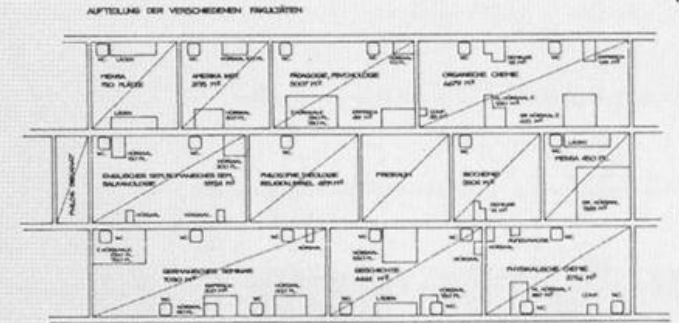
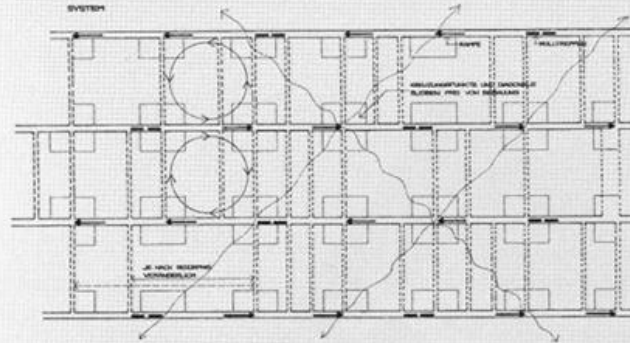

- ANFORDERUNG UND ERGÄNZUNG
- NACH DEM VERHALTEN
- ENTWICKELUNG DER
- STRUKTUREN
- NACH DEN ANFORDERUNGEN DER
- VERSCHIEDENEN FUNKTIONEN
- NACH DEN VERHÄLTNISSEN
- UND VERGEBEN DER
- STRUKTUREN
- NACH DEN ANFORDERUNGEN
- UND VERGEBEN DER
- STRUKTUREN
- NACH DEN ANFORDERUNGEN
- UND VERGEBEN DER
- STRUKTUREN

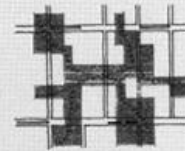
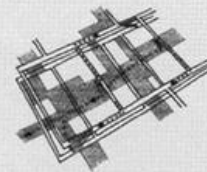

ORGANISATION DER FUNKTIONEN

FÜHRGANGSNETZWERK

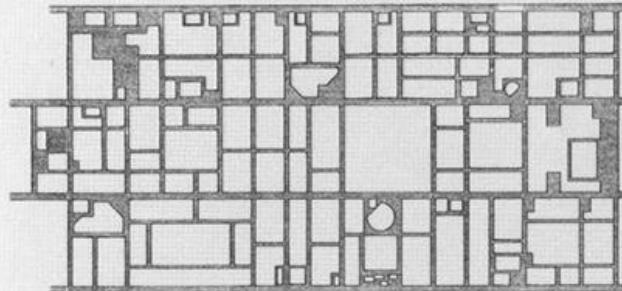

FUNKTIONEN

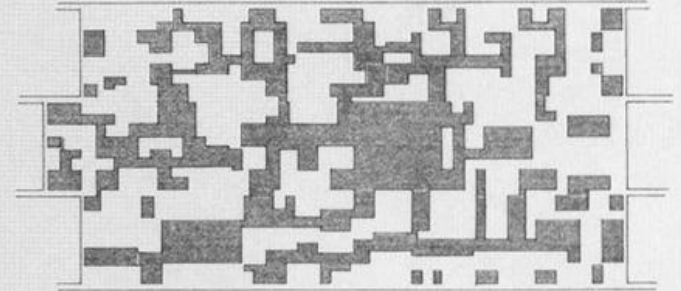

ÜBERLAGERUNG VON FÜHRGANGSNETZEN UND FUNKTIONEN

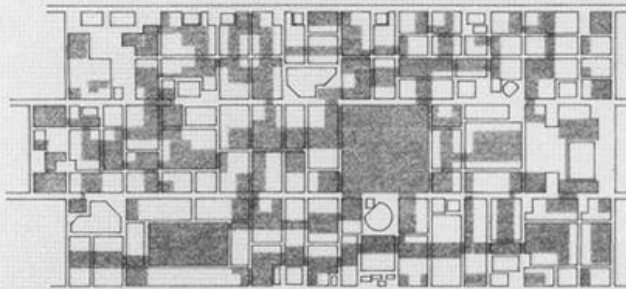

PLANN

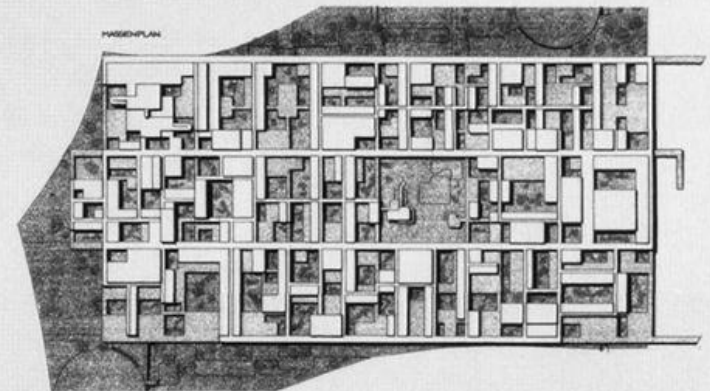

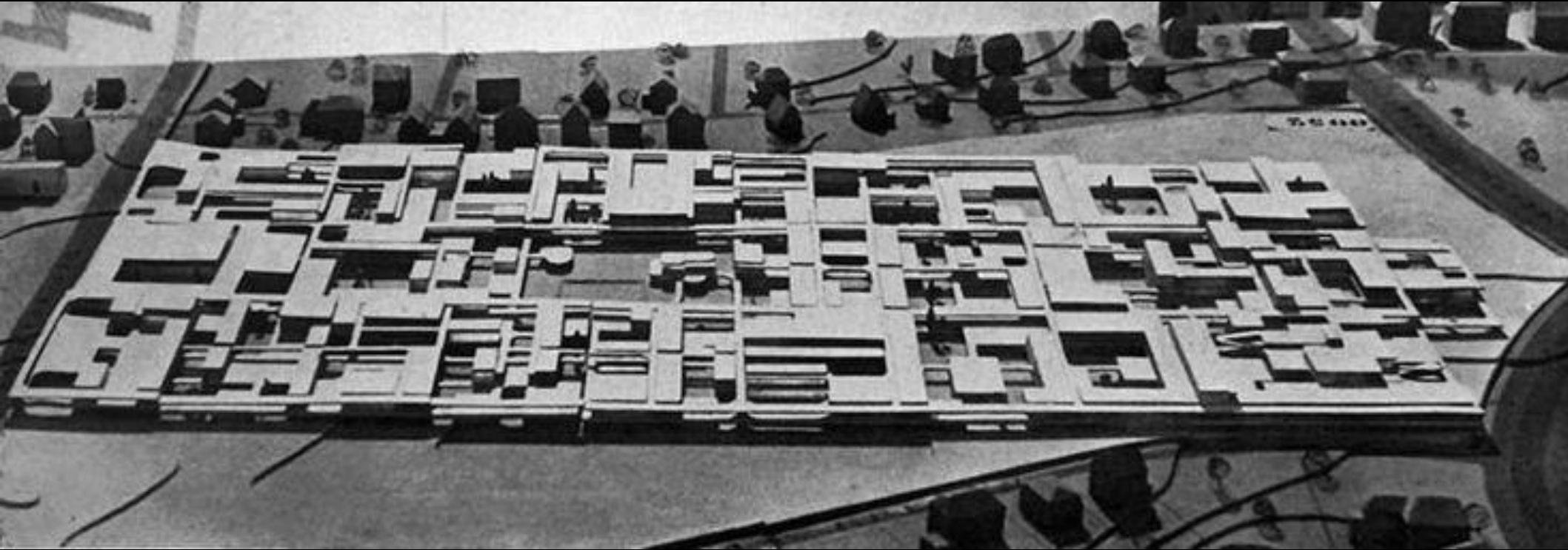

Candilis-Josic-Woods, Berlin University, 1963



Candilis-Josic-Woods, Berlin University, 1963

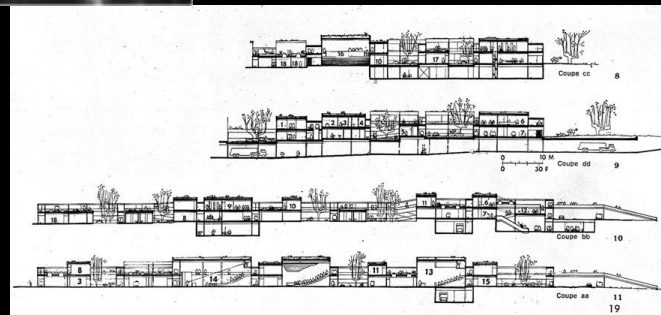

Monument Continu



La Grande Muraille de Chine, 3^e siècle ACN-17^e siècle PCN

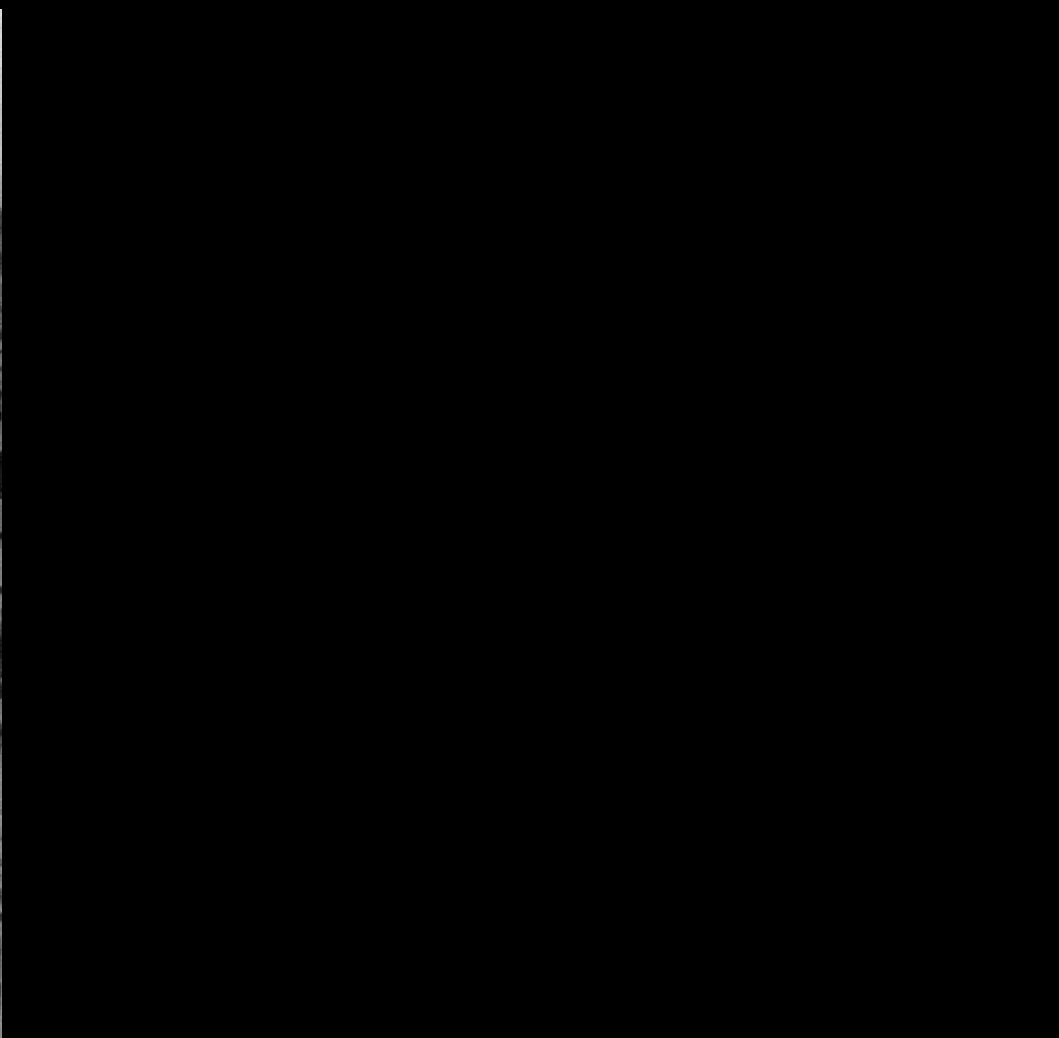

Le Corbusier, Plan Obus, Alger, 1933

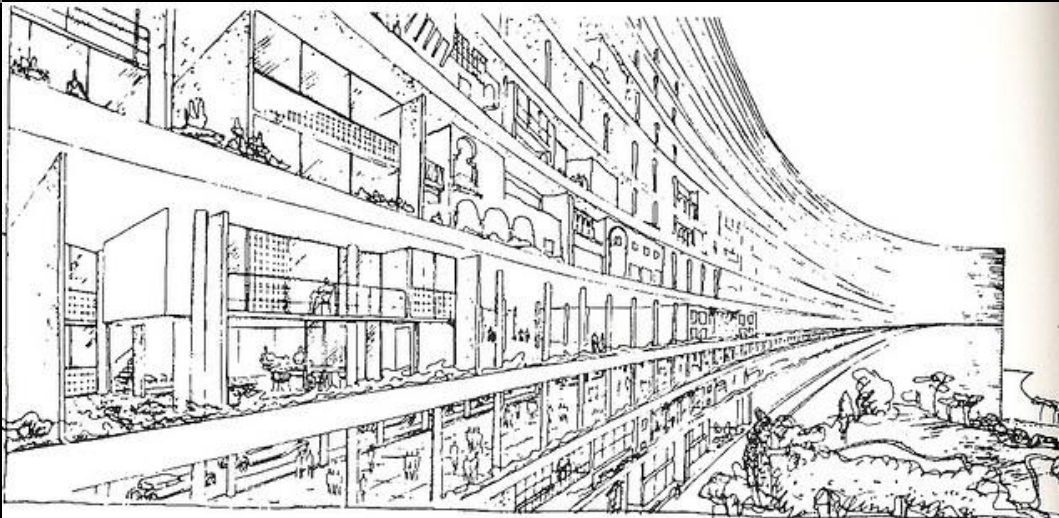

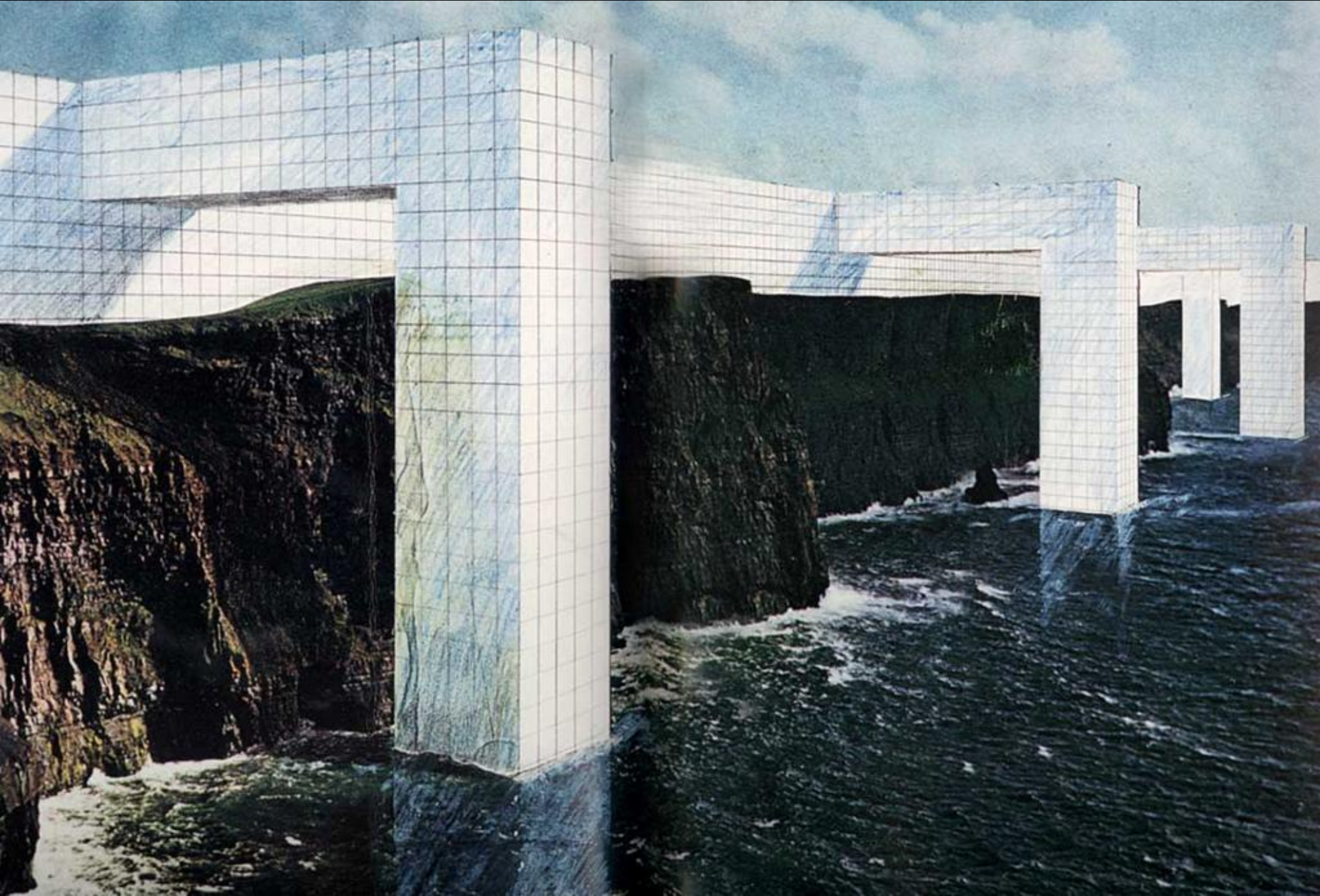

Superstudio, Monumento Continuo, 1969

Rhizome

“ system a-centered, non hierarchical (...) only defined by a circulations of state” Gilles Deleuze and Felix Guattari, 1976

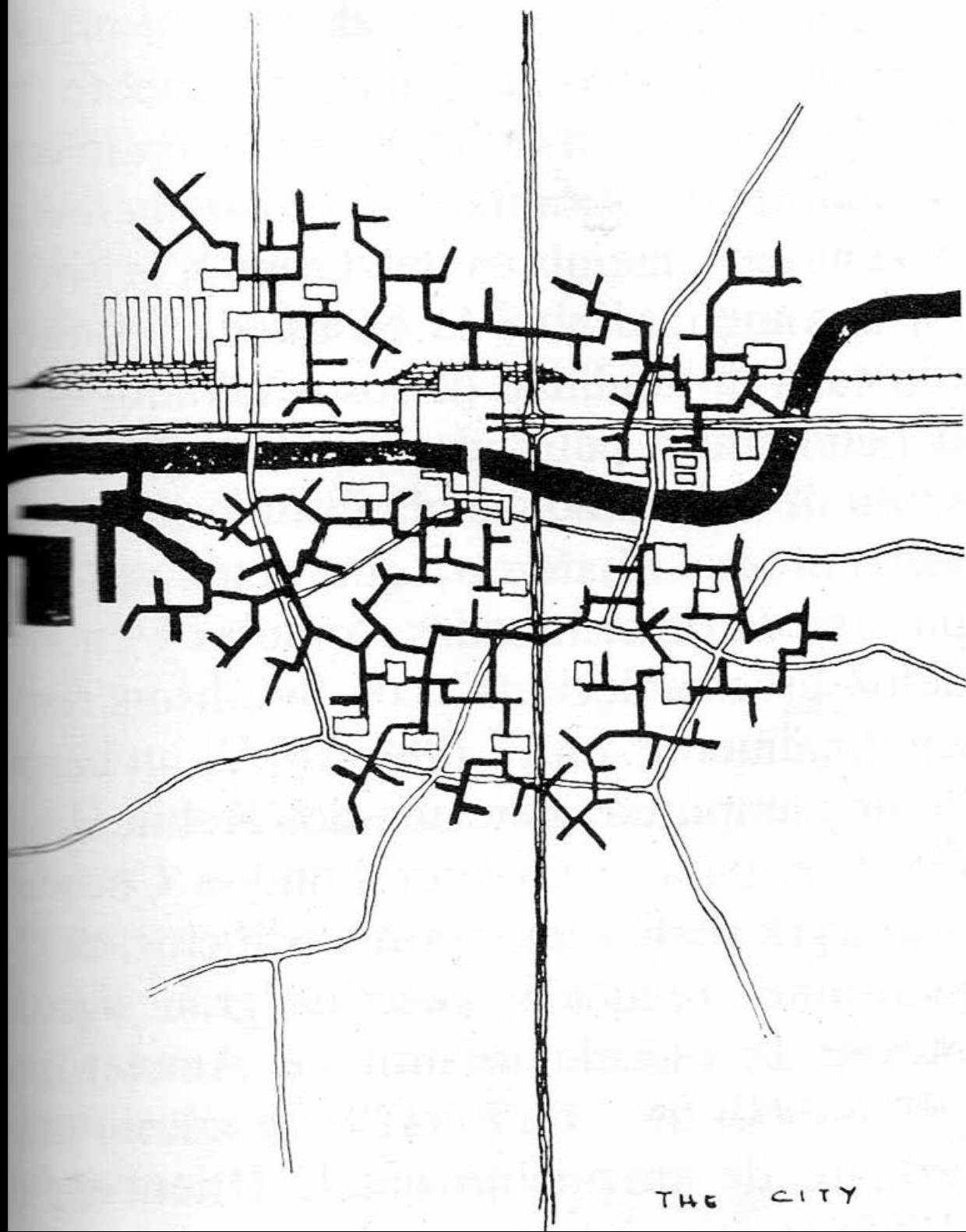

Peter and Alison Smithson, Golden Lane Project,

London, 1952-1953

THE CITY

Peter and Alison Smithson,
Berlin Hauptstadt, 1957

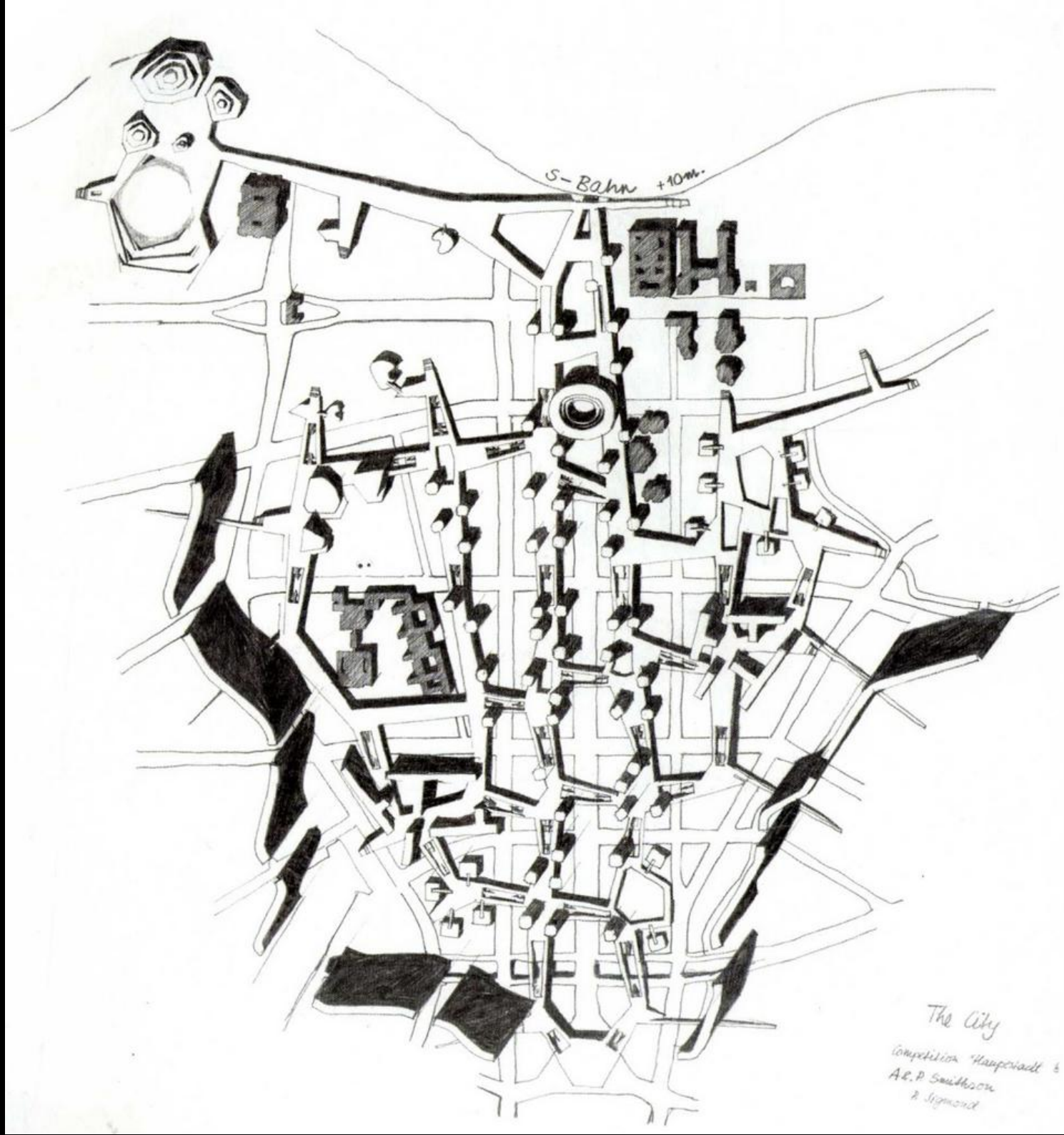

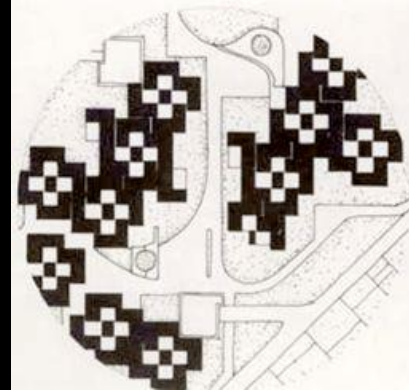
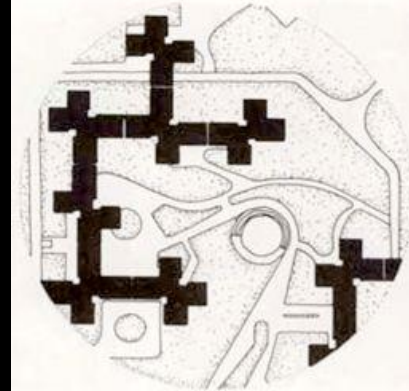
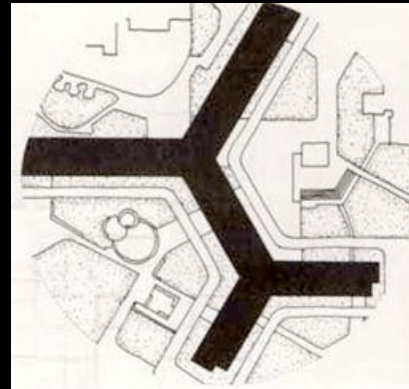
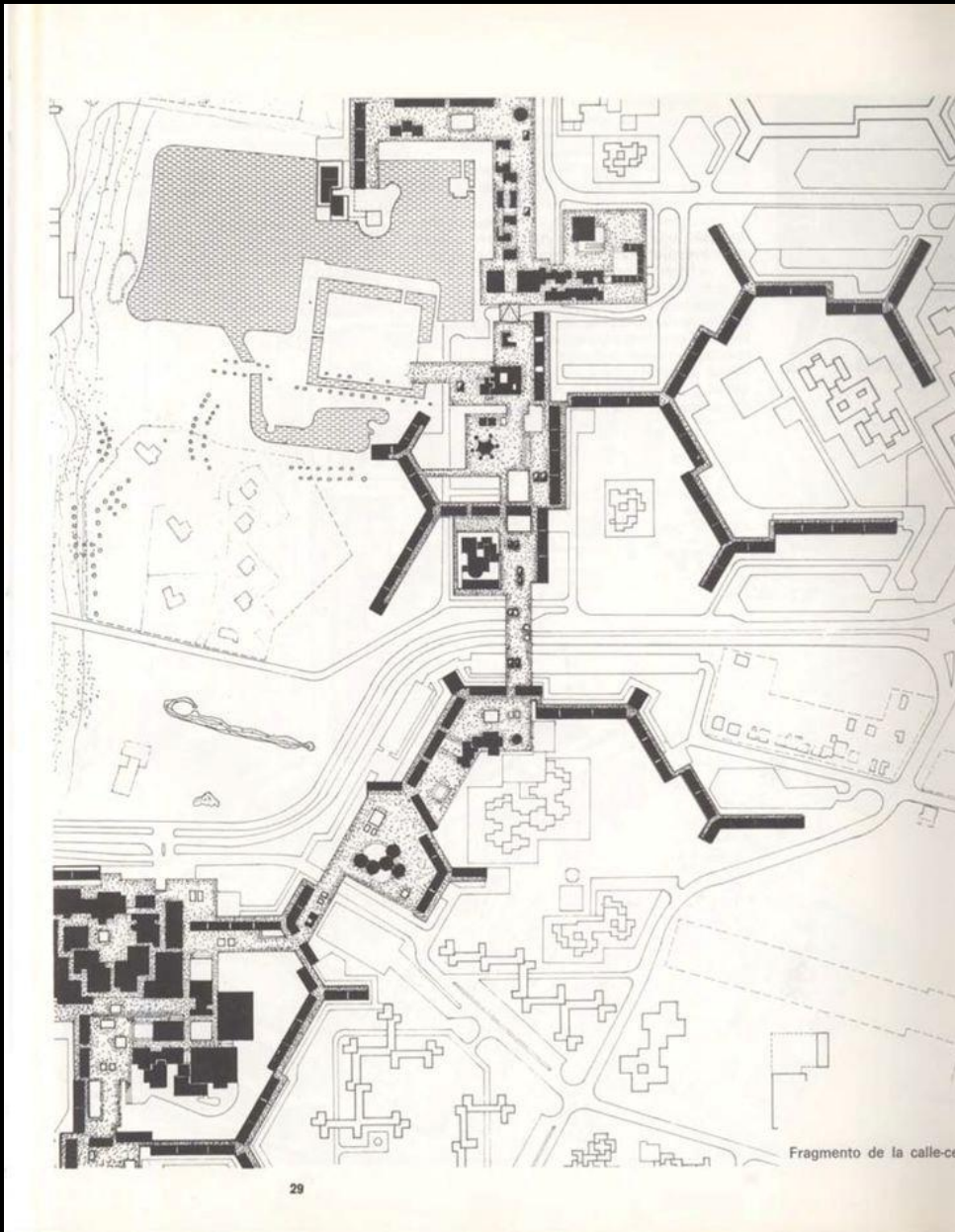

Candilis-Woods-Josic, Toulouse-le-Mitrail, 1961-1971



Candilis-Woods-Josic, Toulouse-le-Mitrail, 1961-1971

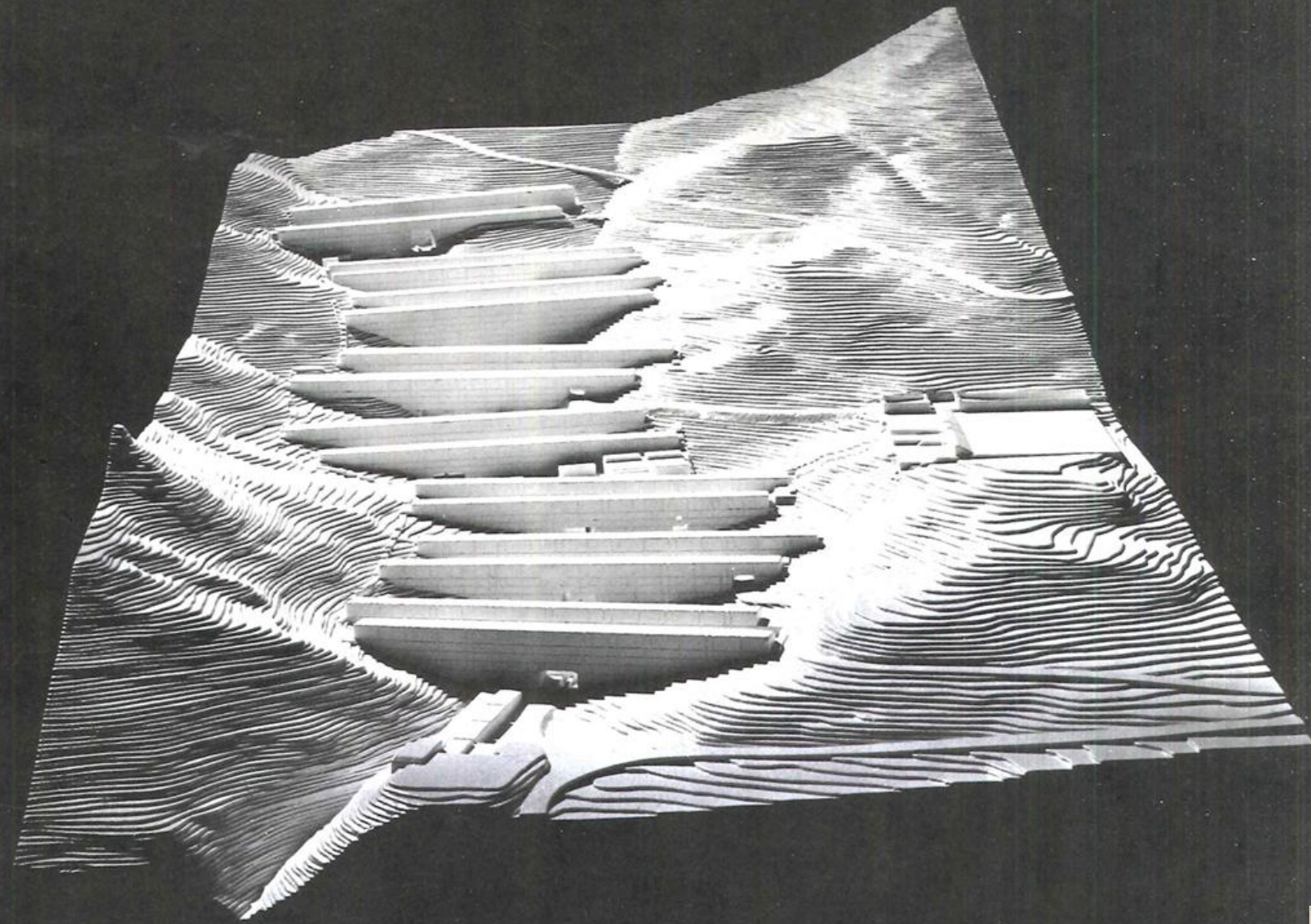

Vittorio Gregotti, Cefalu Social Housing, 1976

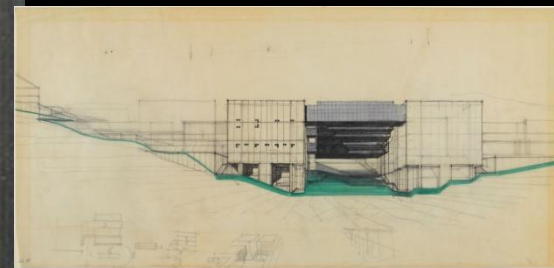

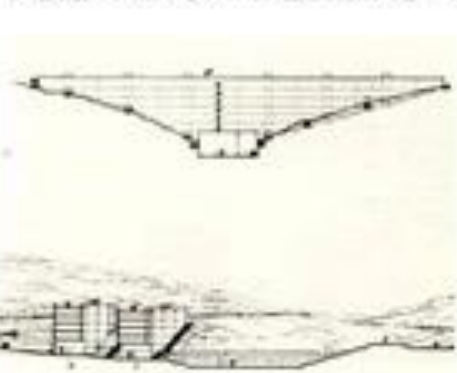
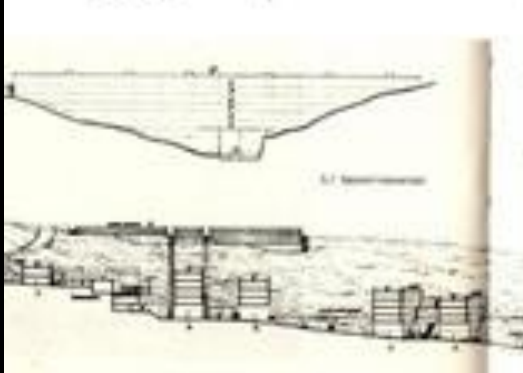
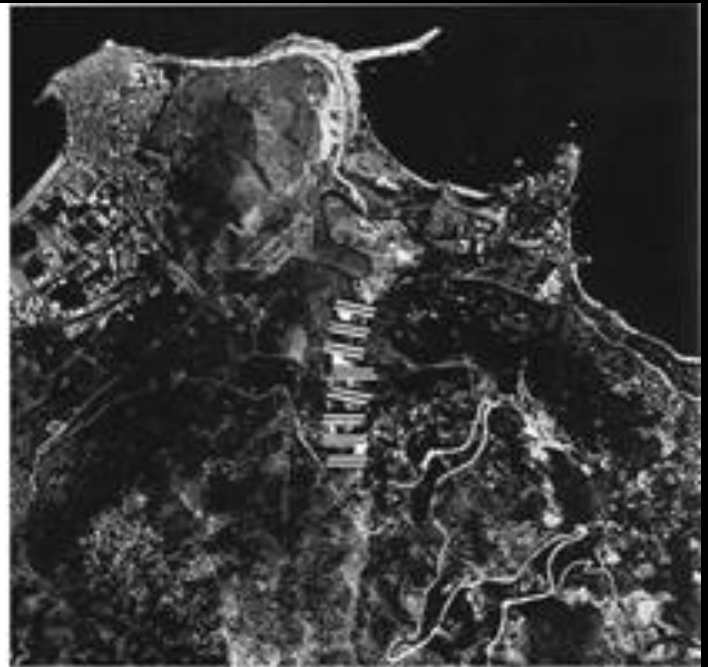
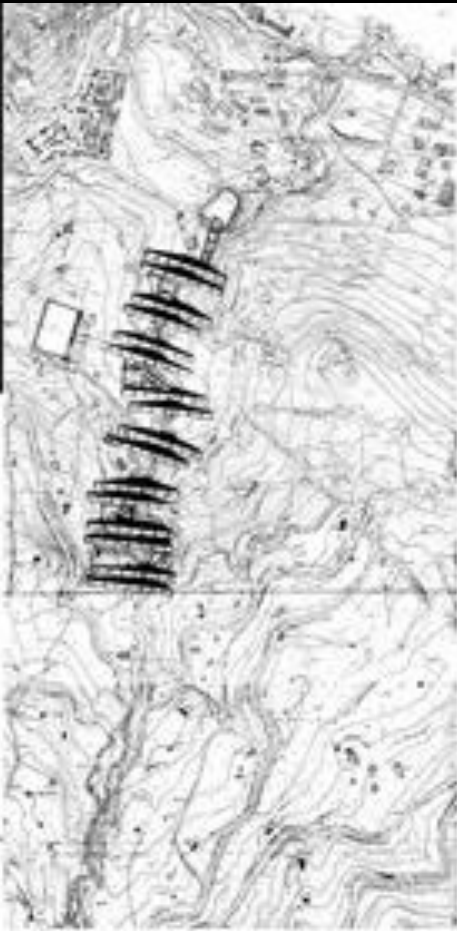
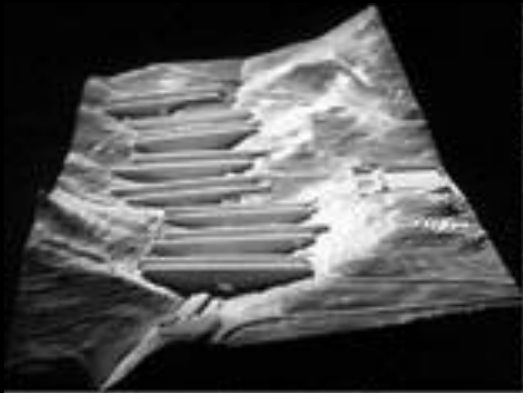

Vittorio Gregotti, Cefalu Social Housing, 1976

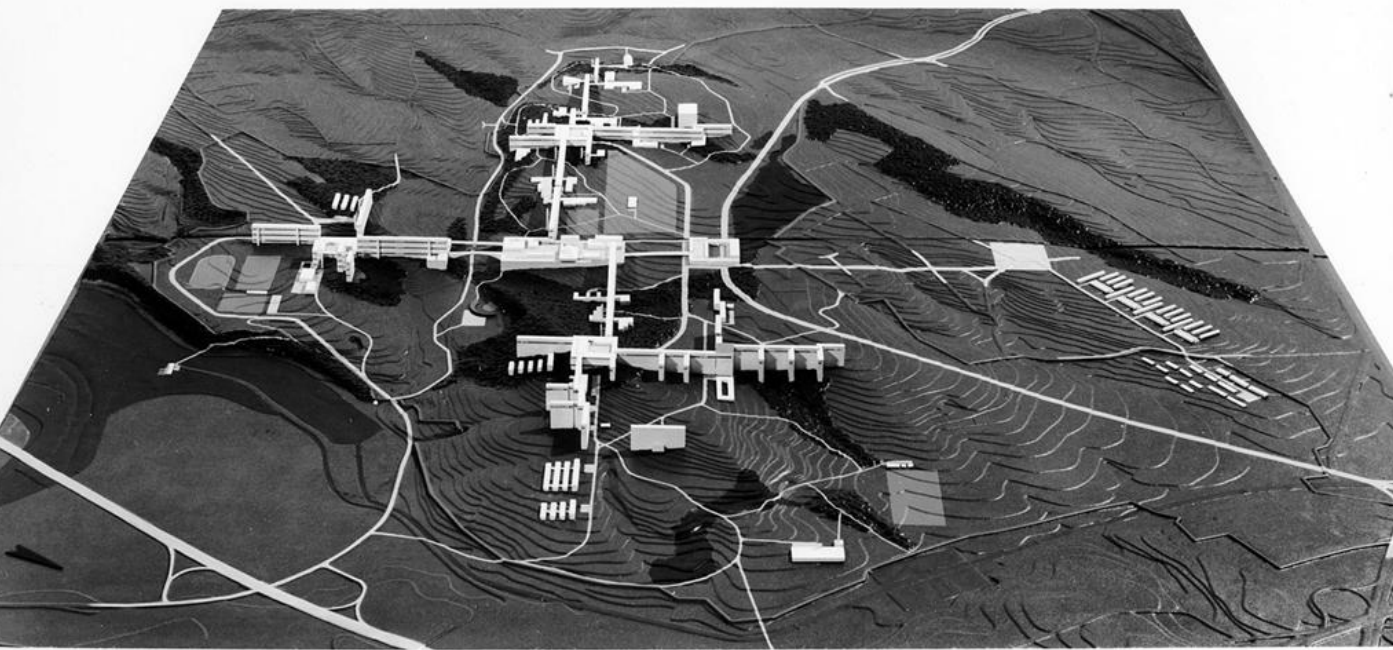

Van den Broeck et Bakema, Bochum University, 1962



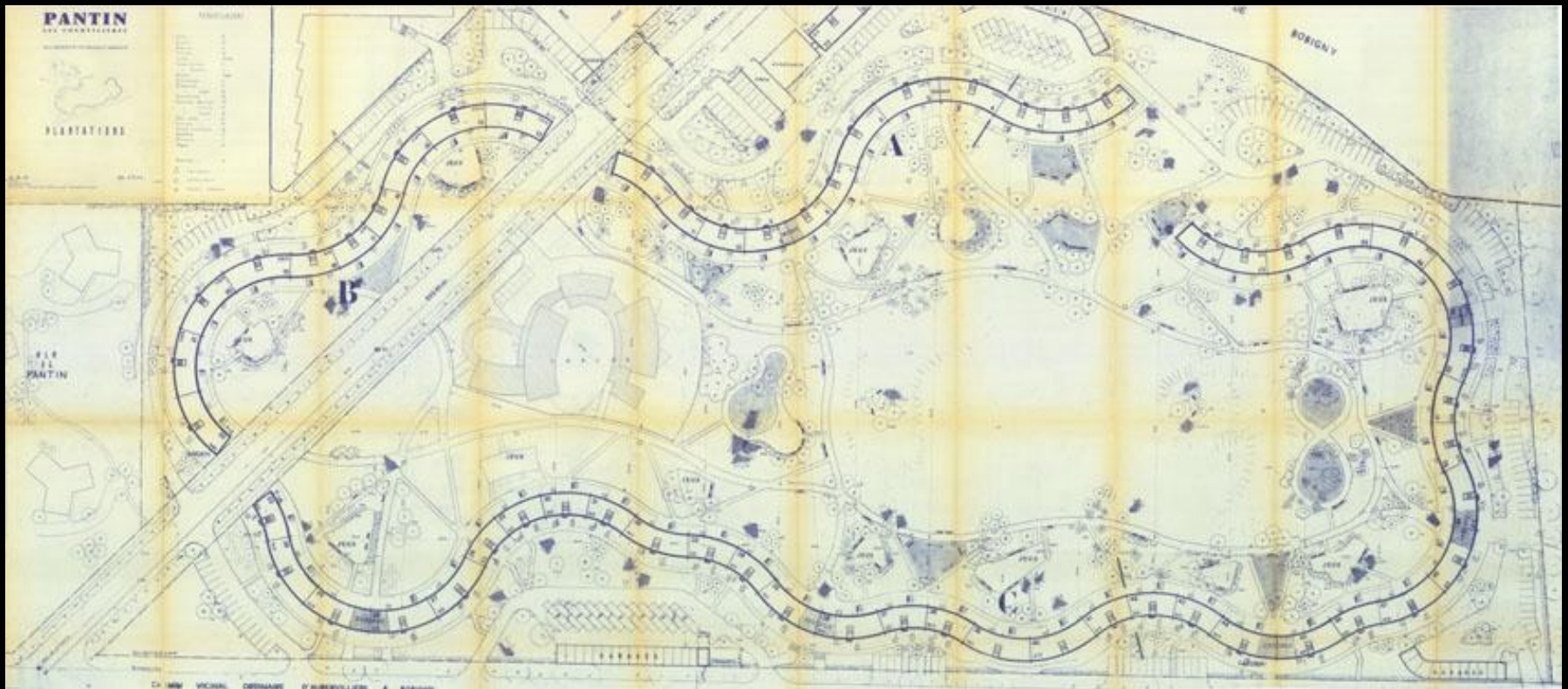

Emile Aillaud, la Grande Borne, 1967



Emile Aillaud, la Grande Borne, 1967

Empilement



Ile de plastique, Océan Pacifique

Combinatoire et complexité tridimensionnelle

“To the general astonishing, a protein molecule, architecture of a rare complexity in three dimensions, is reduced to a structure of a particular simplicity in one dimension. (...) The complexity in the space is given by folding of the chain on itself(...). What confers to the molecule its specific form, it's the length of the chain, a hundred to a thousand units, et the sequence in which are contained these units. The diversity and the complexity are once again obtained by the simplicity of a combinatory”

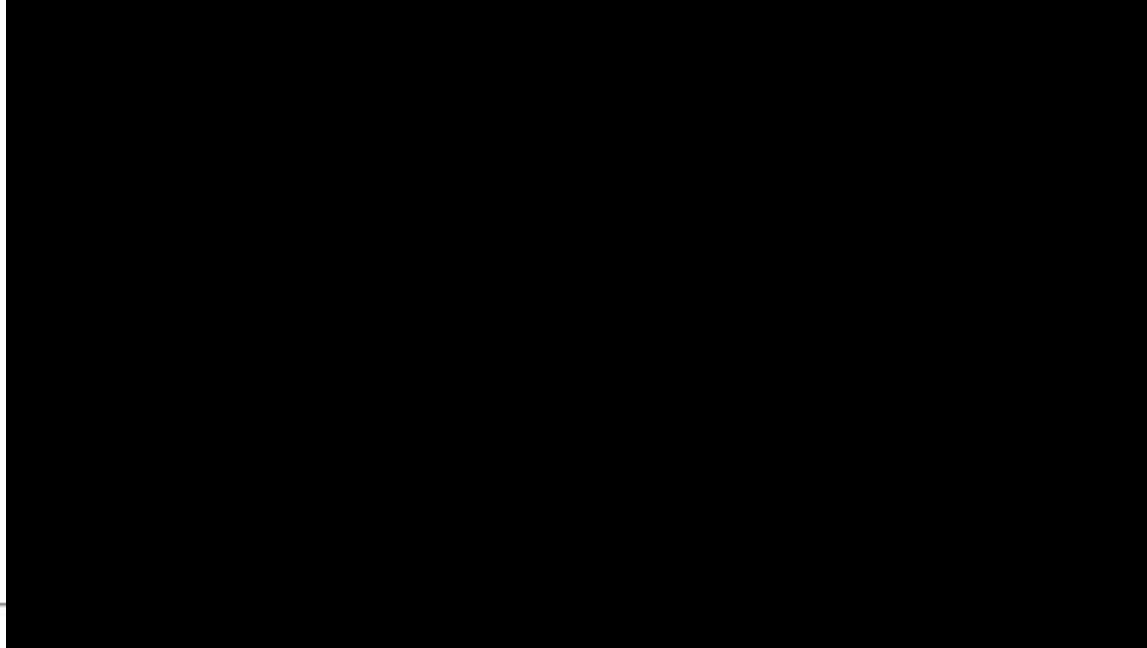
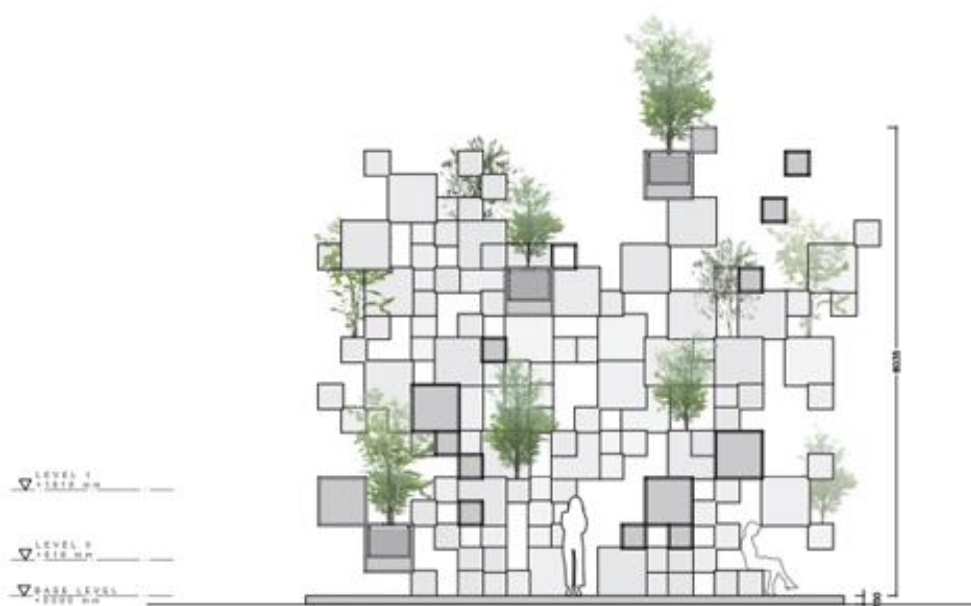

Sou Fujimoto, Many small cubes, Paris, 2014

It was intended for the capsules to be replaced every 25 years. It has now been 27 and the capsules are beginning to decay. The core is designed to last 100 years.

Due to the lower design only the top capsules can be removed. To replace a lower capsule requires removing all capsules above it first.

Asbestos
Earthquake Protection
General ware

Has amounted in the residents calling for the building to be replaced.

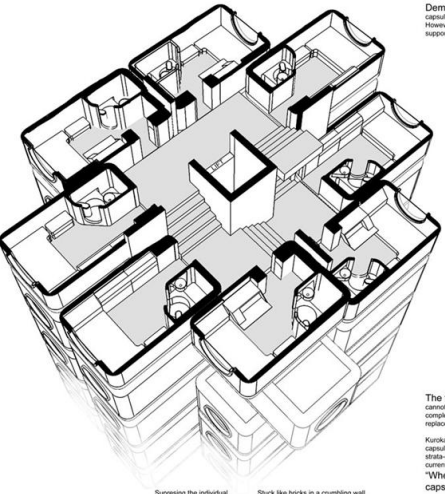

Demolition was approved in 2007, the capsules aged 35 years, 10 more than planned. However the tower still stands thanks to global support for the iconic metabolist structure.



The future of the capsule tower is uncertain; it cannot remain as is. The building has two options, complete demolition or have the capsules replaced.

Kurikawa is at fault here by not enabling the capsules to be individually replaced. 140 strata-owners must agree for anything to happen currently. Kurikawa must answer, "Where does one trade-in for a new capsule?"

Supressing the individual Stuck like bricks in a crumbling wall

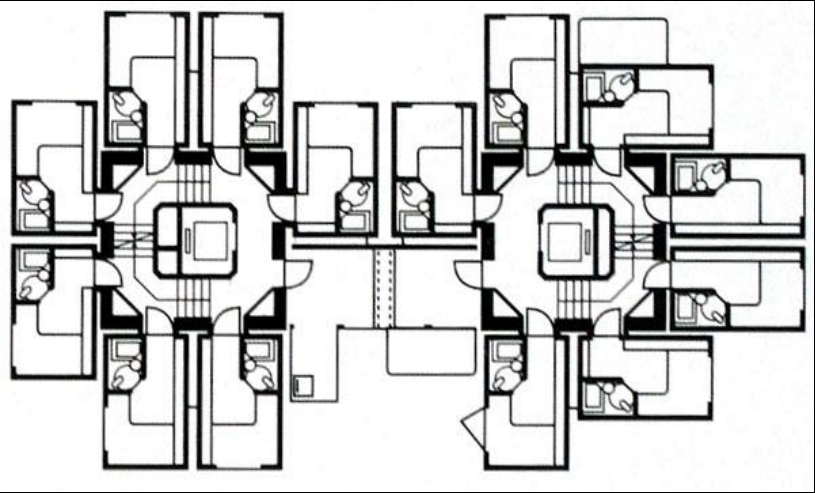

Kisho Kurokawa, Nagakin tower, Tokyo, 1972



Moshe Safdie, Habitat 67, Montreal



José Antonio Coderch, Las Cocheras, Barcelone, 1969

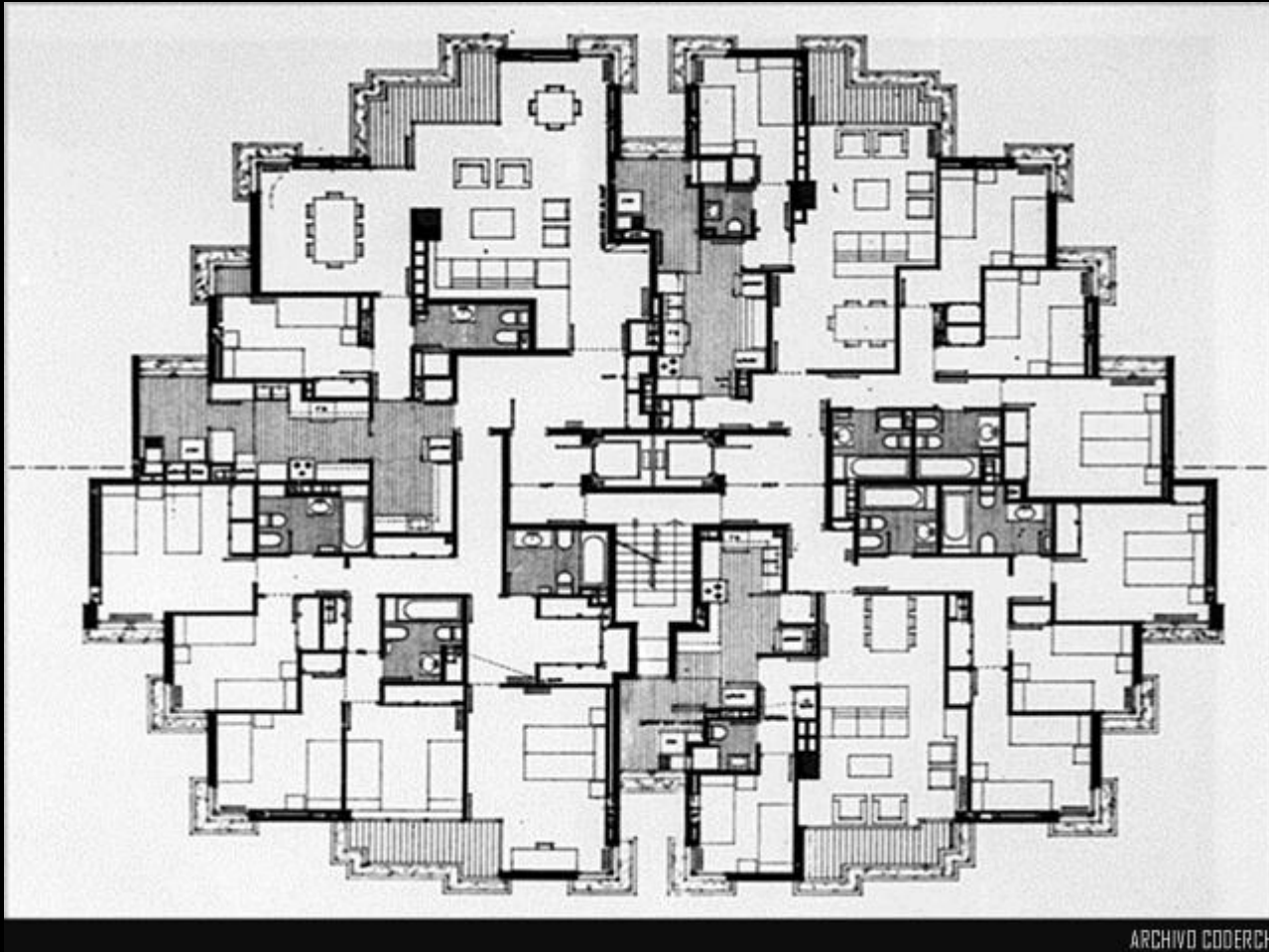

José Antonio Coderch, Las Cocheras, Barcelone, 1969



Sou Fujimoto, Tokyo apartment, 2006



Herzog et de Meuron, VitraHaus, Weil am Rhein, 2006



Herzog et de Meuron, VitraHaus, Weil am Rhein, 2006



Herzog et de Meuron, VitraHaus, Weil am Rhein, 2006

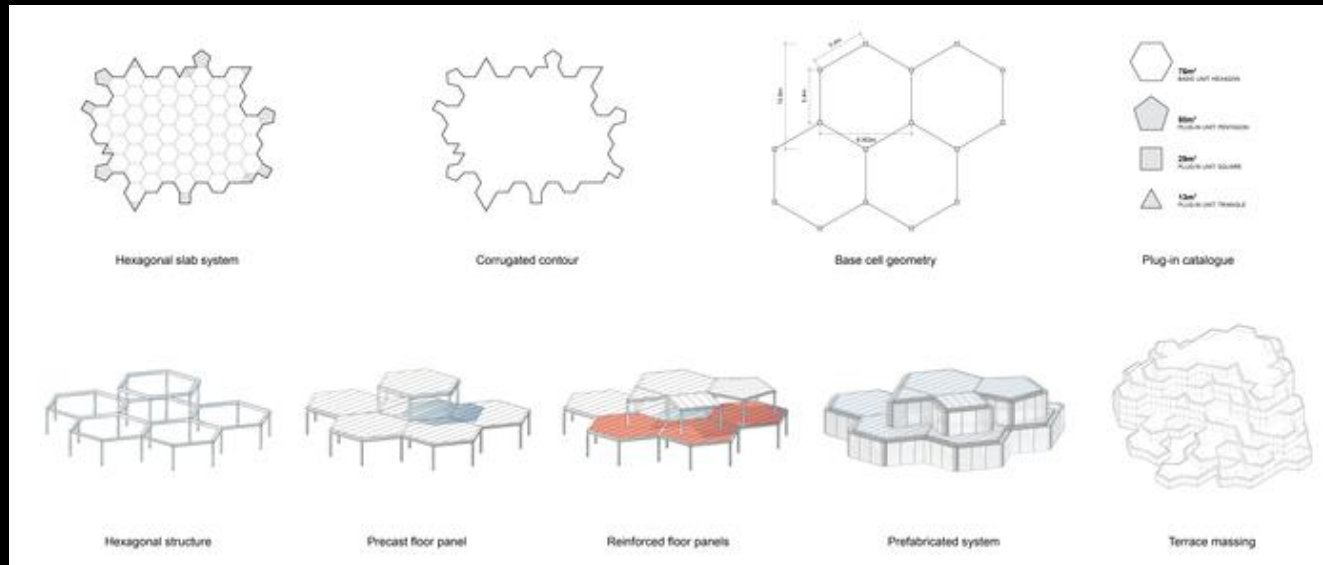
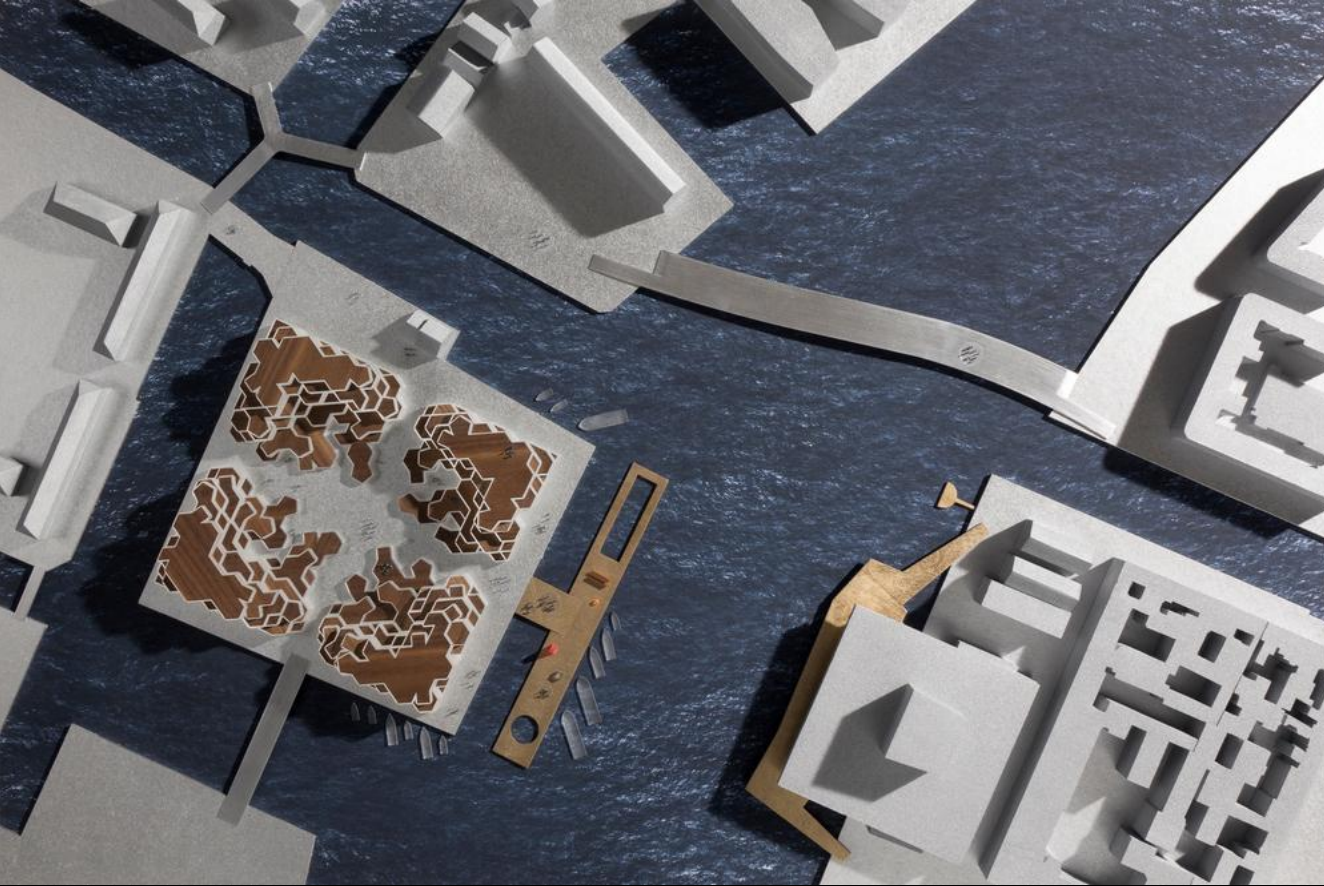

OMA, Christianholm Island, 2015



1976 Roads Ministry Tbilisi / Georgia



1976 Roads Ministry Tbilisi / Georgia



Sanaa, Extension of Moma, New York, 2002

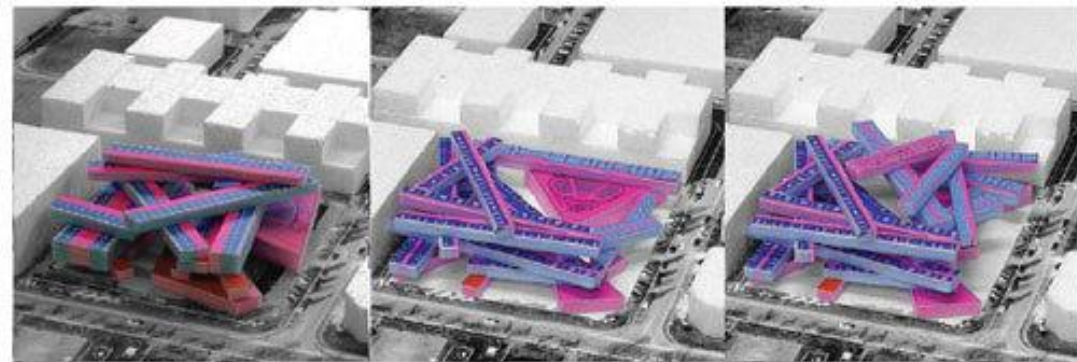
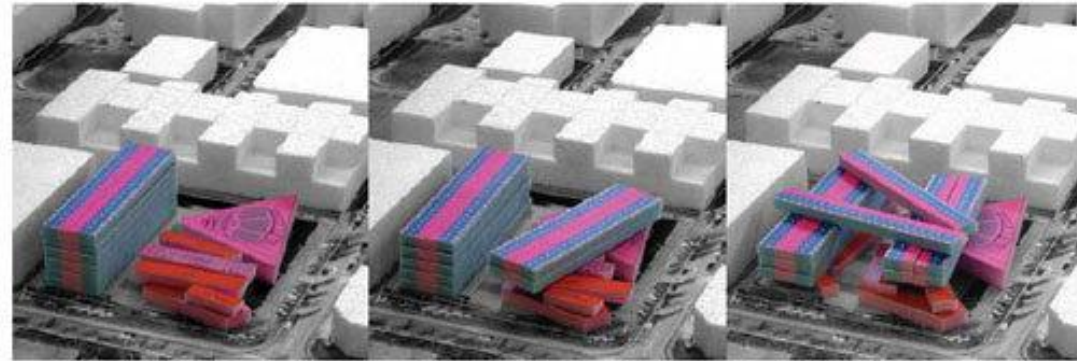
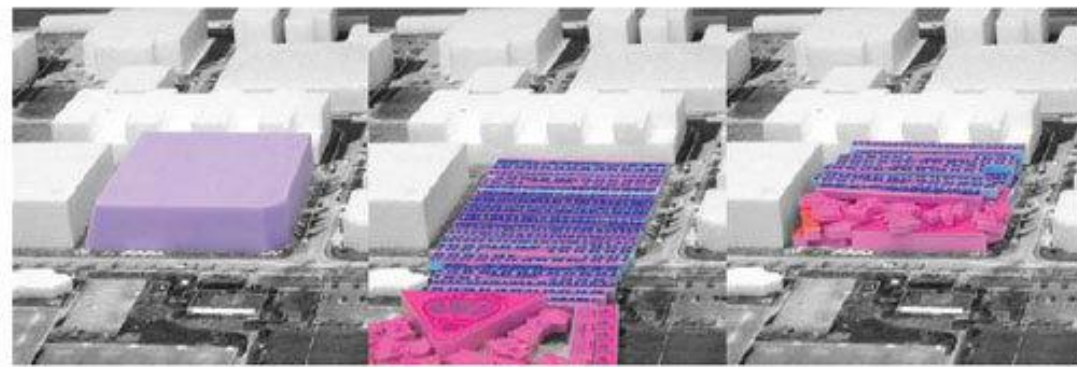
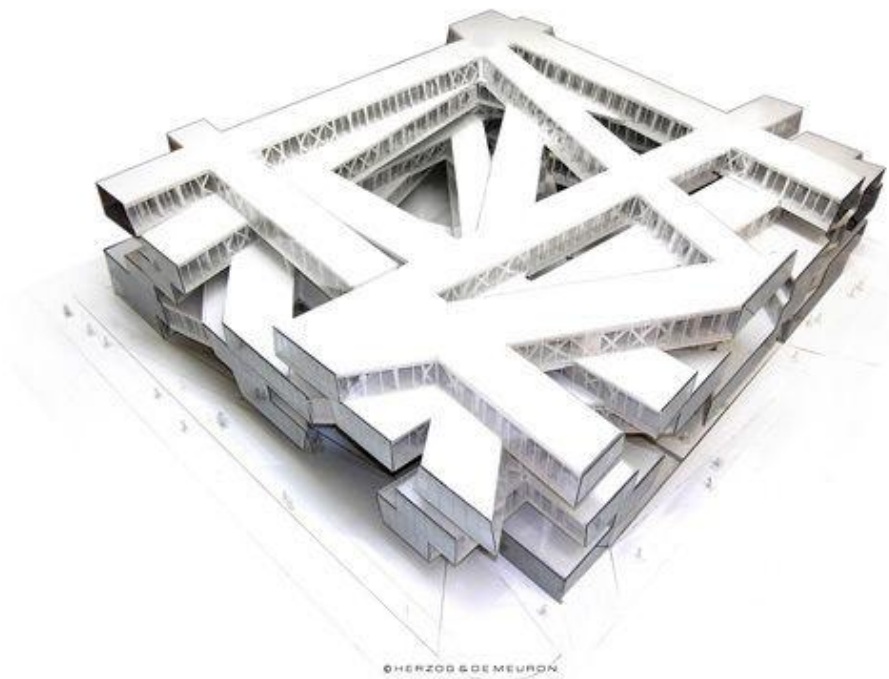

Herzog et de Meuron, Actelion Headquarter, 2005



Herzog et de Meuron, Actelion Headquarter, 2005

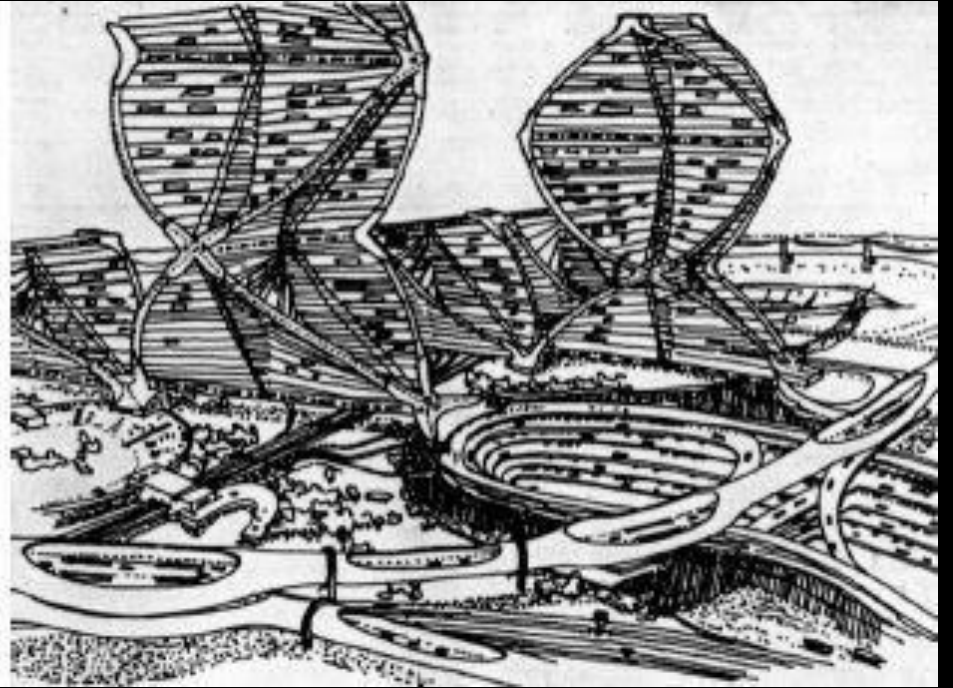
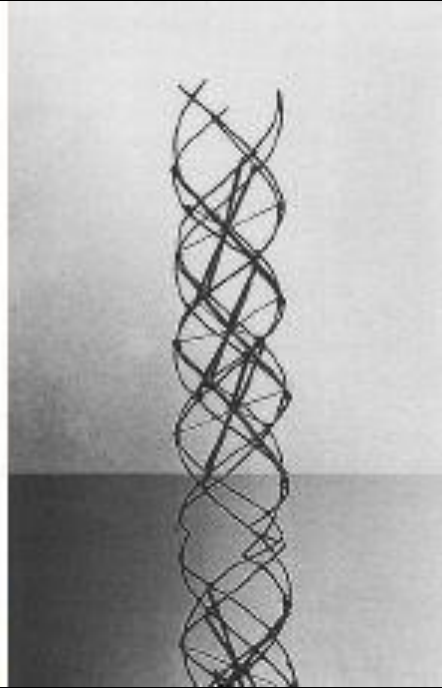

Kisho Kurokawa, Helix City, 1962

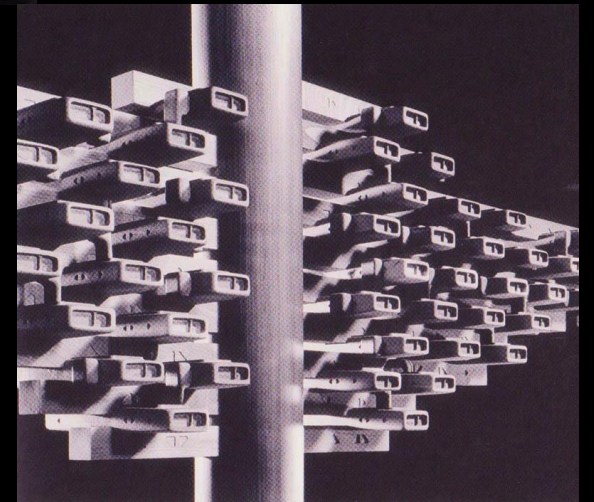
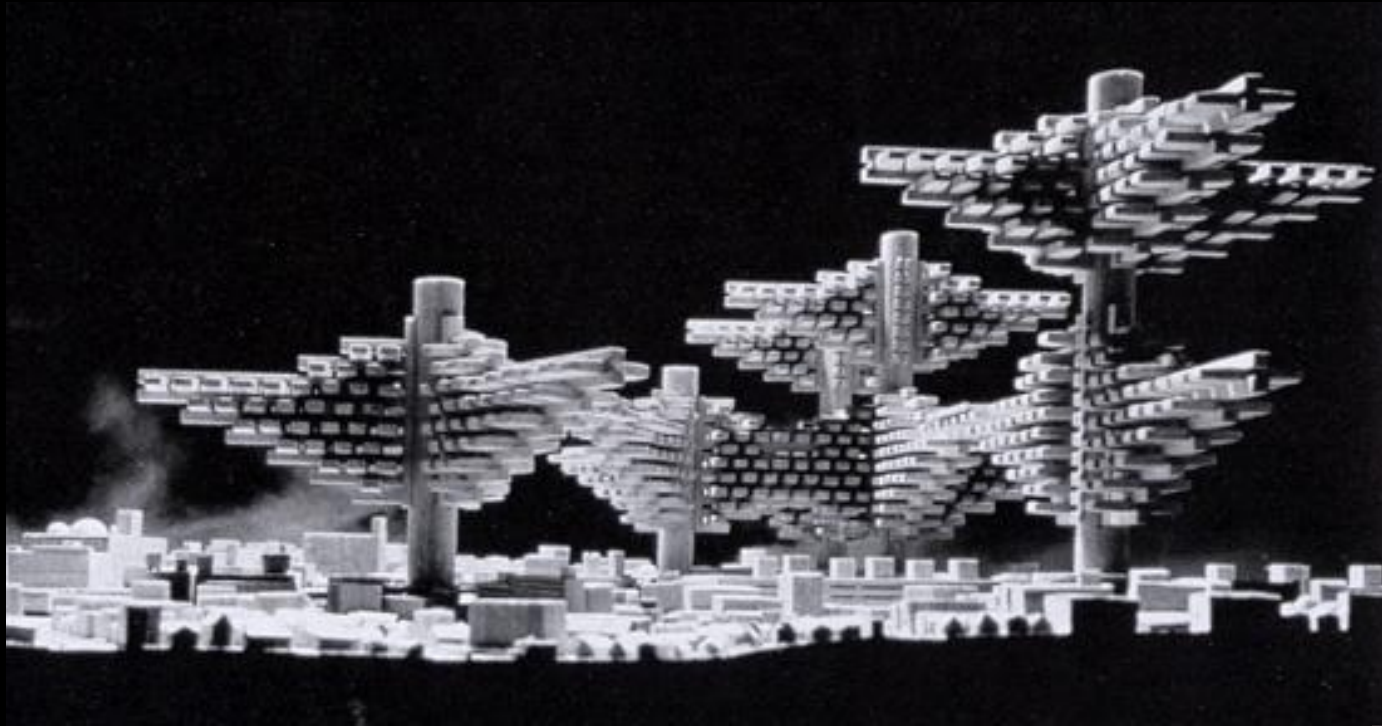

Arata Isozaki, Clusters in the air, 1962

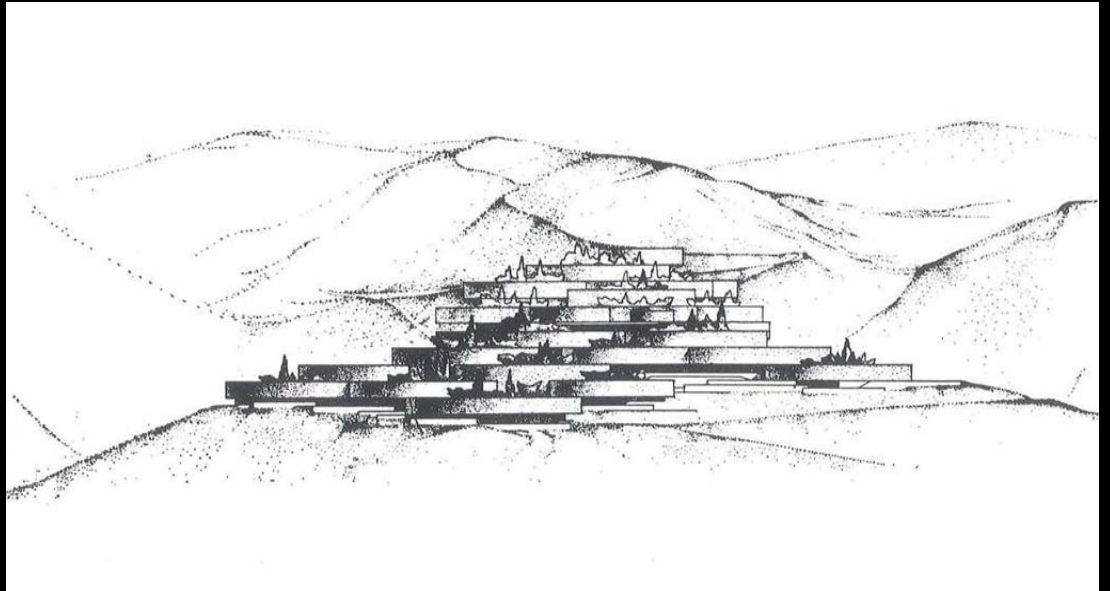
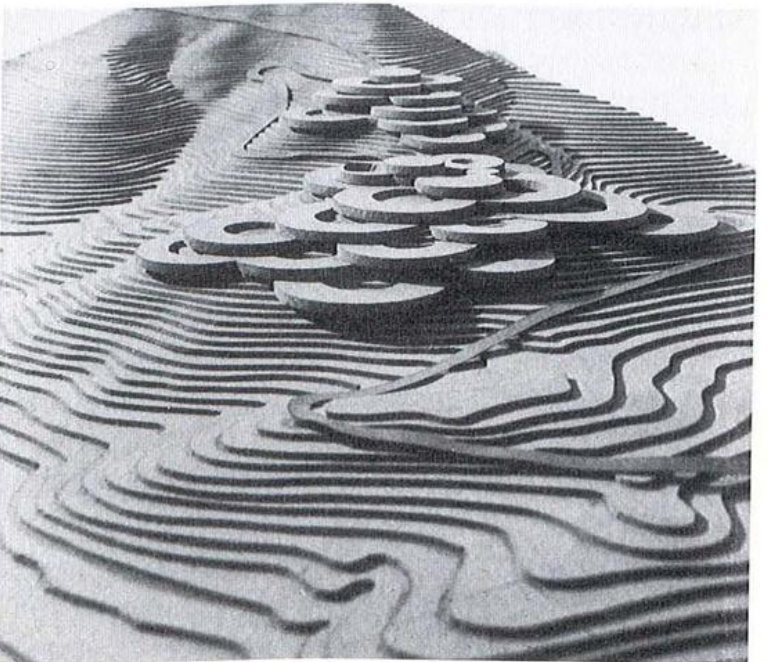
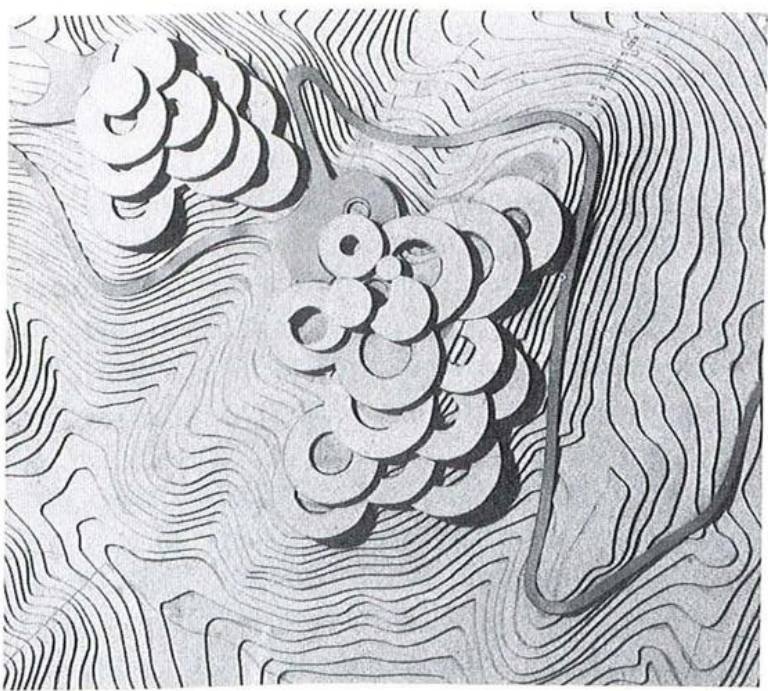

Aterlier de Montrouge, Housings, Gigaro, 1963

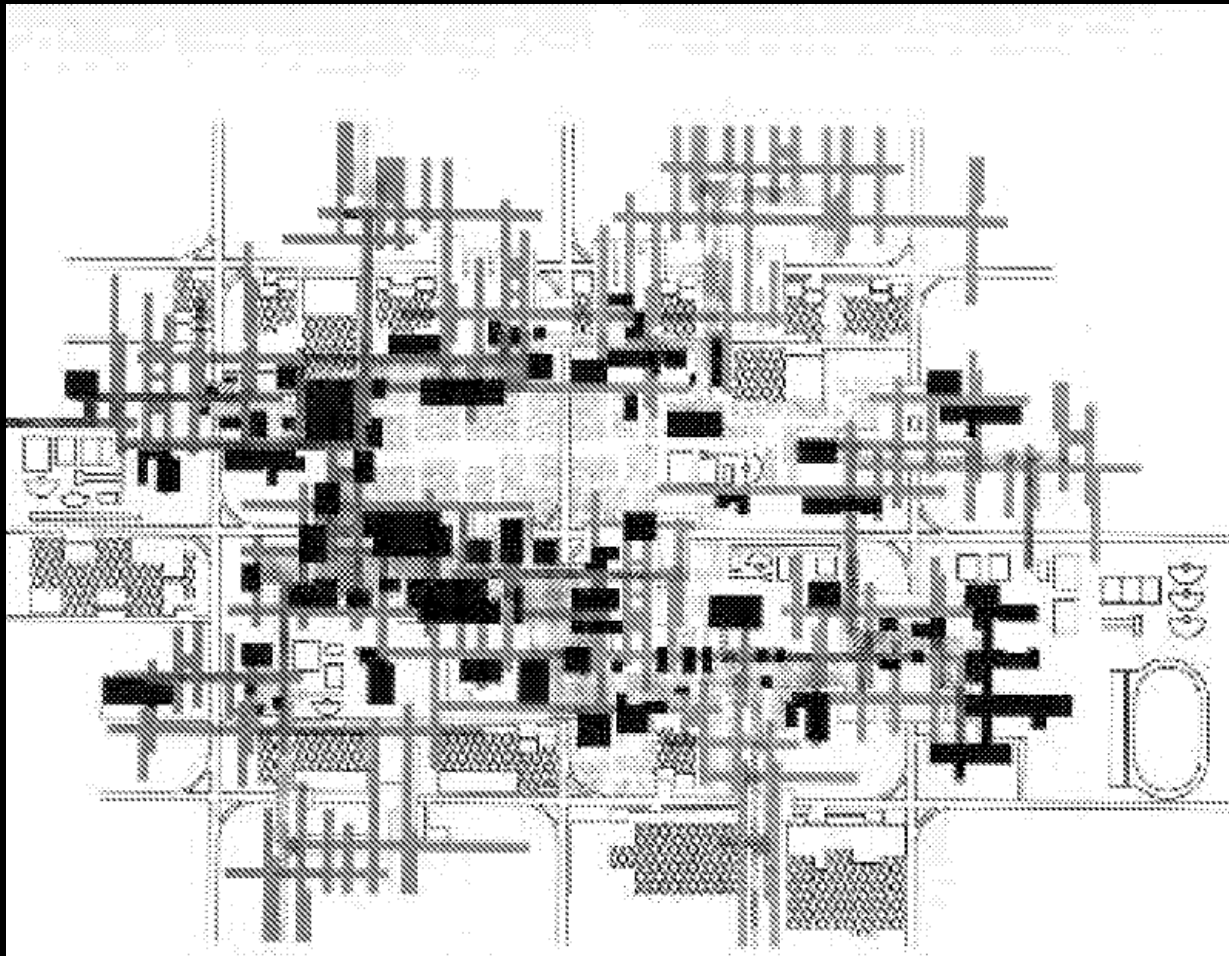
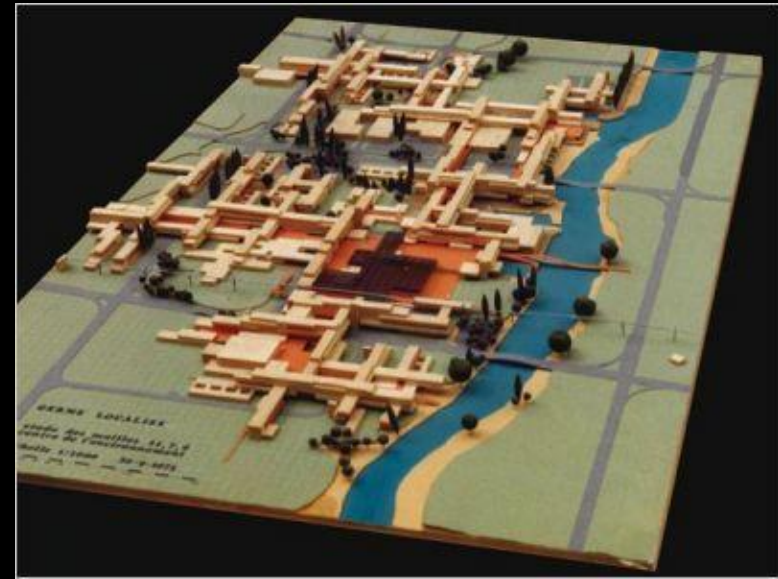
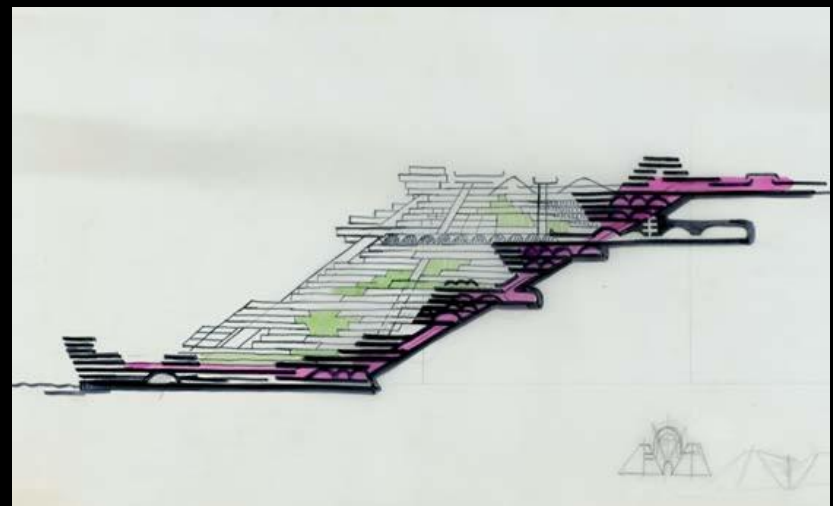

Figure 2 : Mission d'aménagement de la ville nouvelle du Vaudreuil, Étude théorique du germe
- plan de synthèse, publié dans Les cahiers de l'Institut d'aménagement et d'urbanisme
de la région parisienne (IAURP), n° 30, février 1973, p. 56.



IDEE DE VOLUME D'ENSEMBLE



Aterlier de Montrouge, Le Vaudreuil, 1967-1968



Atelier de Jean Renaudie, Vitrolles, 1976



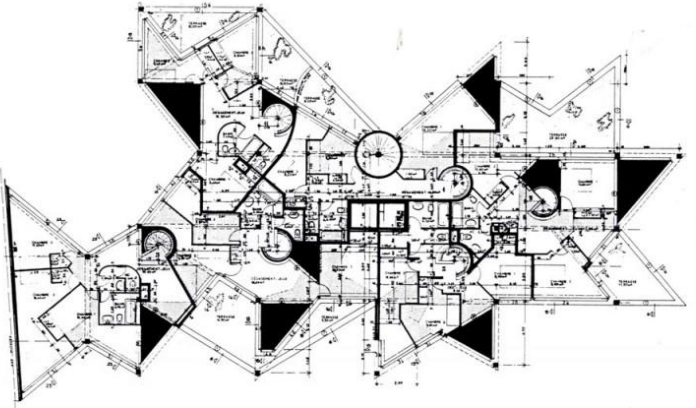
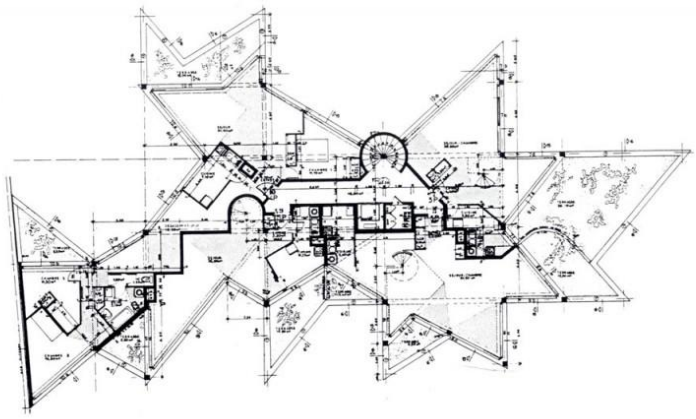

Atelier de Jean Renaudie, Ivry-sur-Seine, 1978

Aggrégation-dispersion



Casbah, Algier



CARRIÈRES CENTRALES A CASABLANCA
Réalisation d'un ensemble de trames à rez-de-chaussée et immeubles

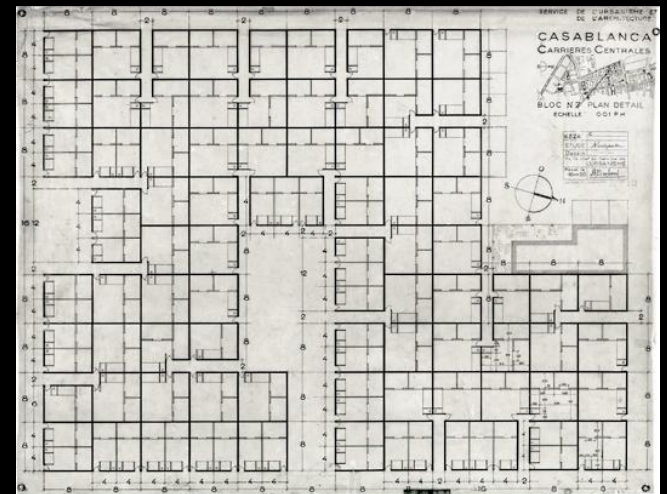

Michel Ecochard team, *Les Carrières Centrales*, Casablanca, 1953



Candilis Georges, *Les Carrières Centrales*, Casablanca, 1953

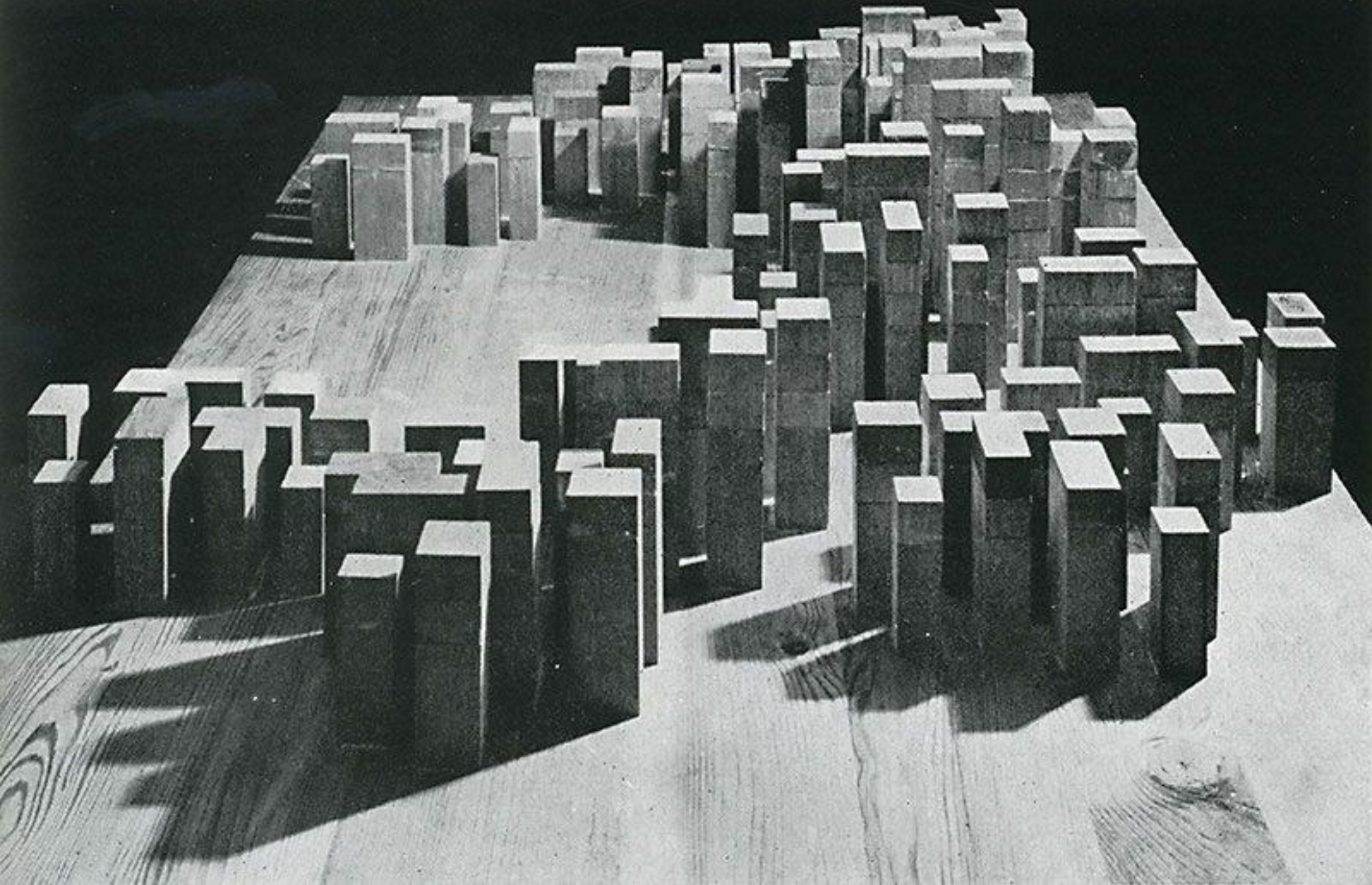

O.M. Ungers, Neue Stadt, Cologne, 1961

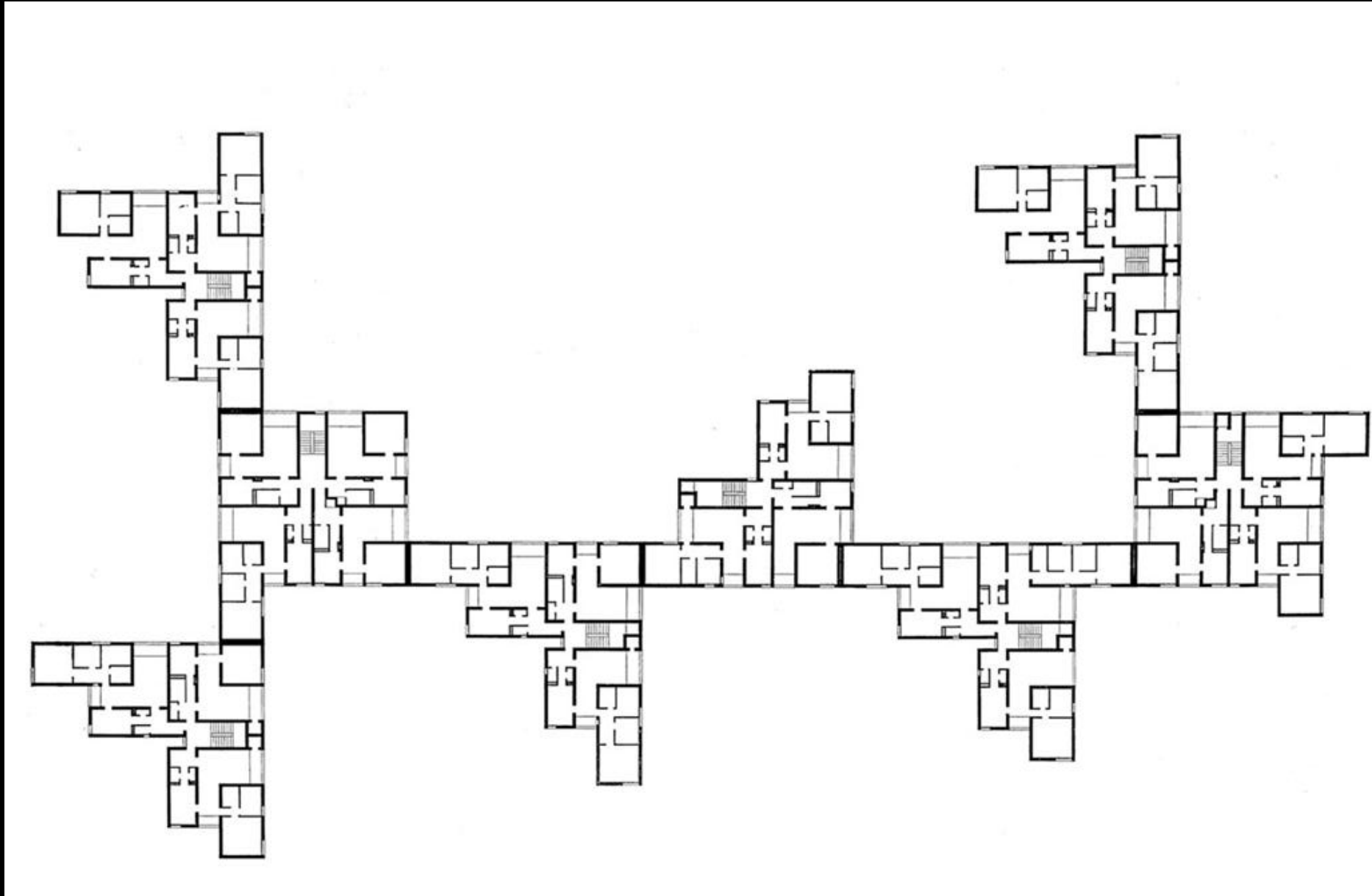

O.M.Ungers, Neue Stadt, Cologne, 1961

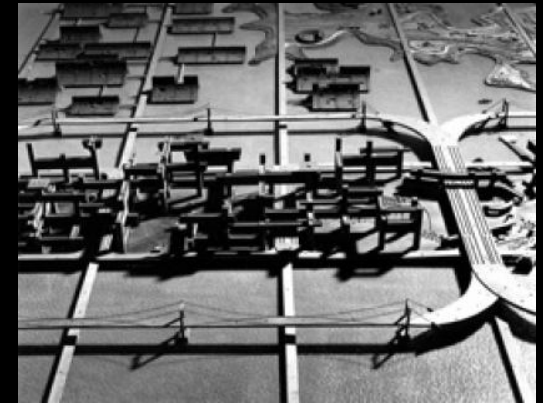
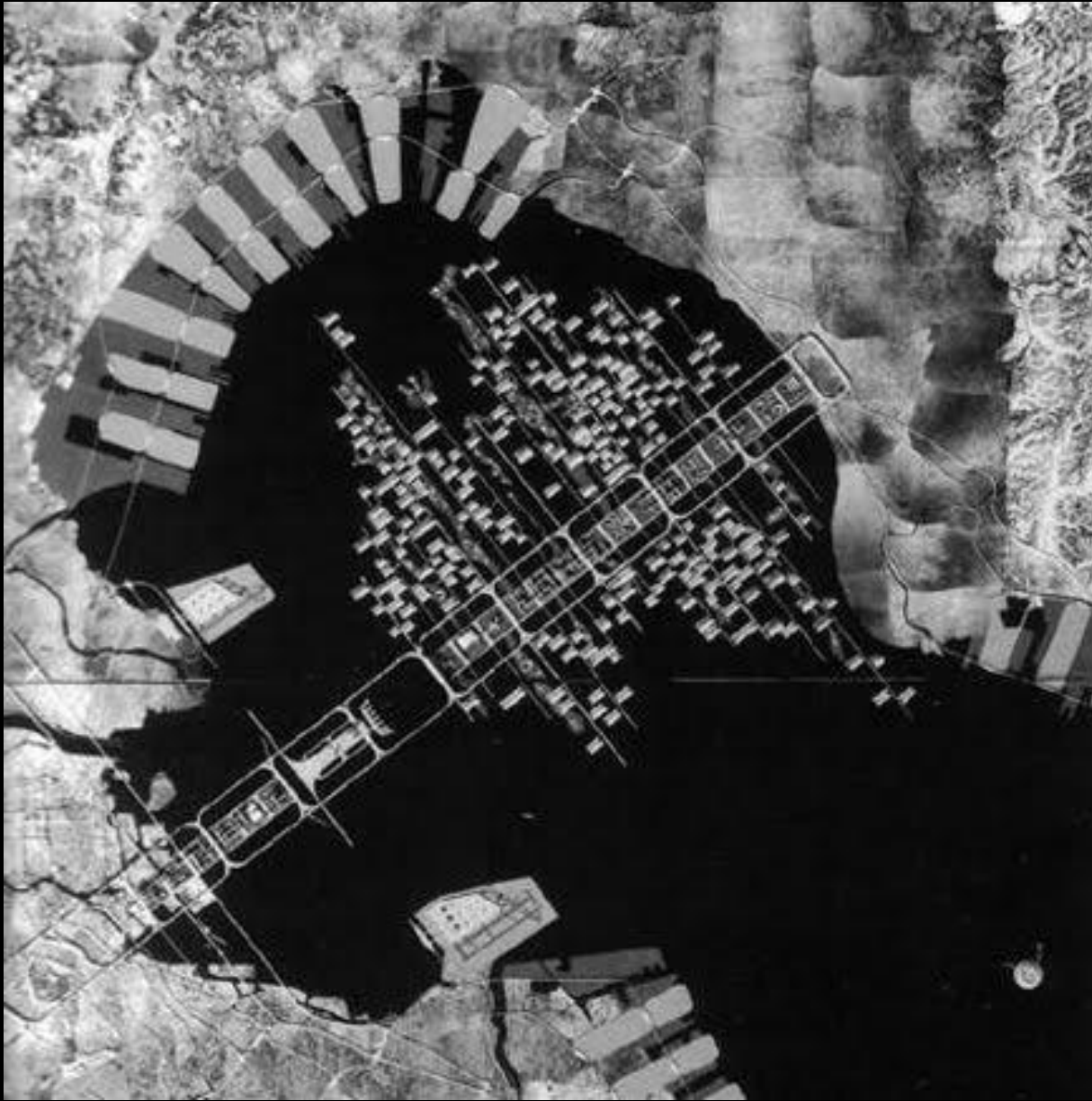

Kenzo Tange, Tokyo bay plan, 1960

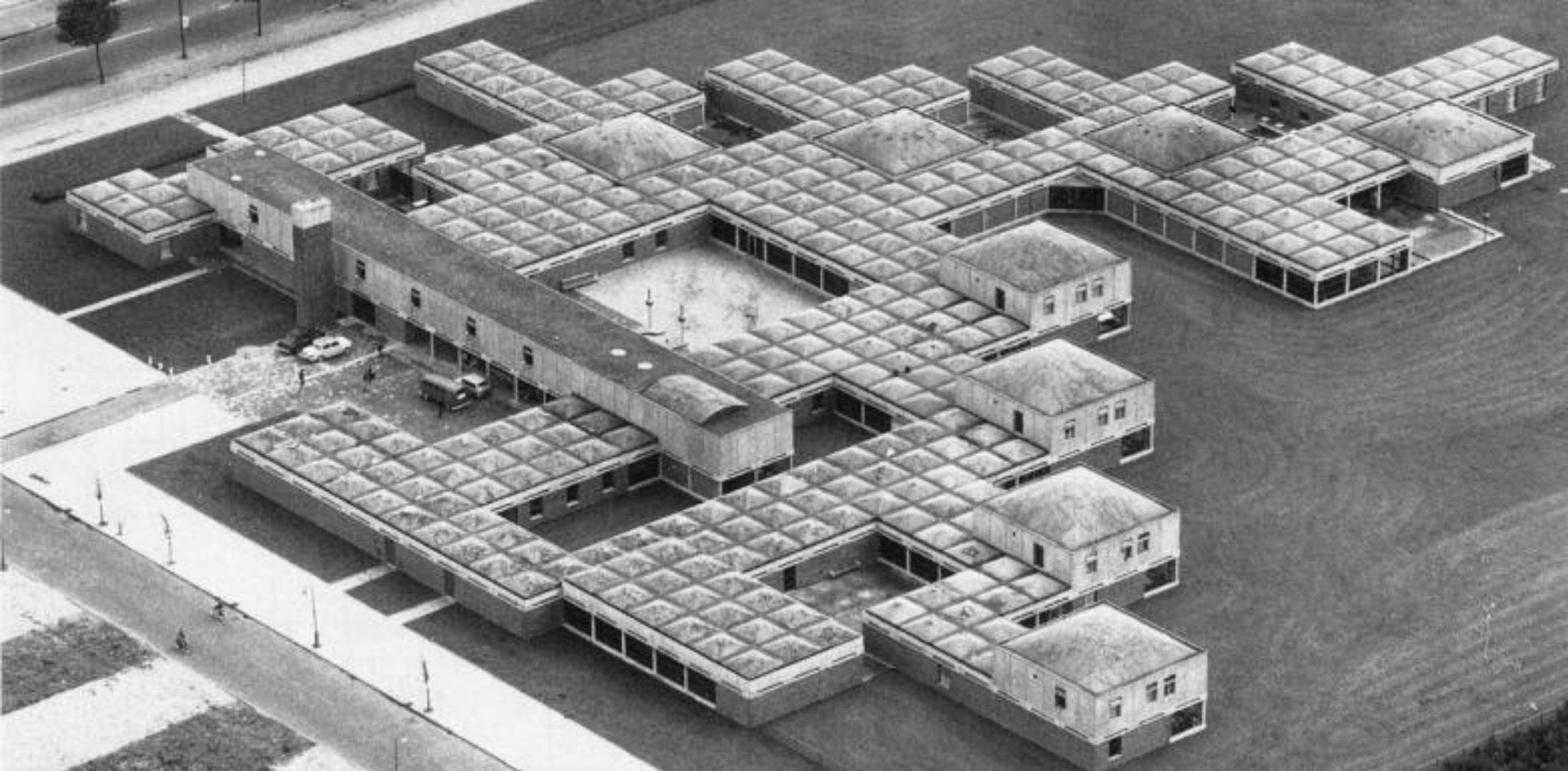

Aldo Van Eyck, Orphanage, Amsterdam, 1960



Herman Hertzberger, Centraal Beheer, Apeldoorn, 1968

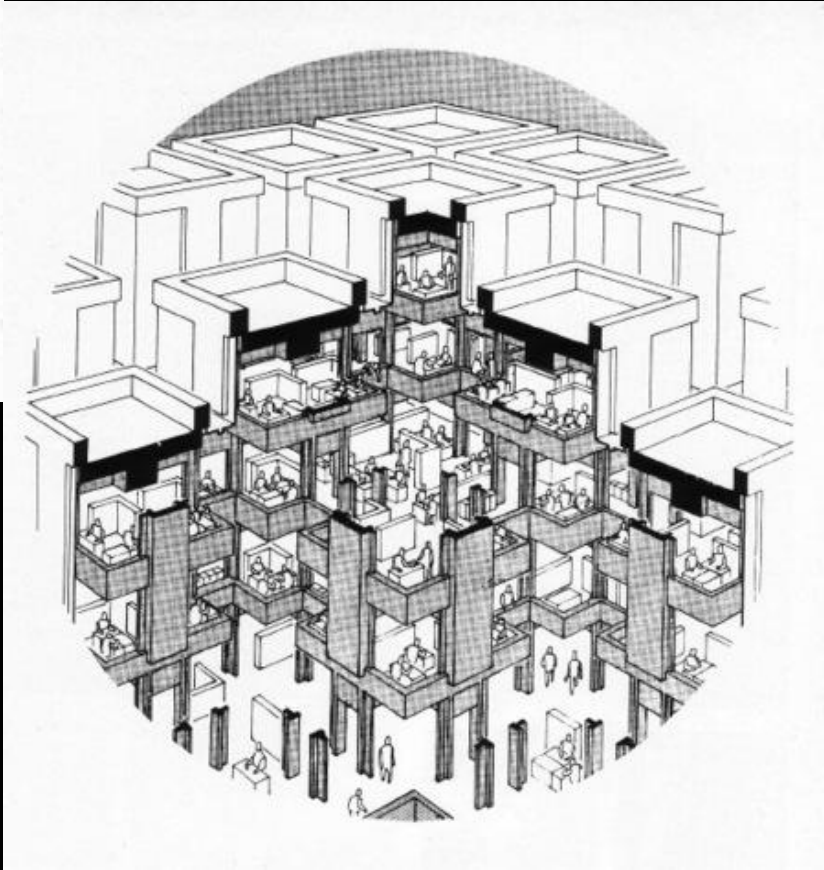
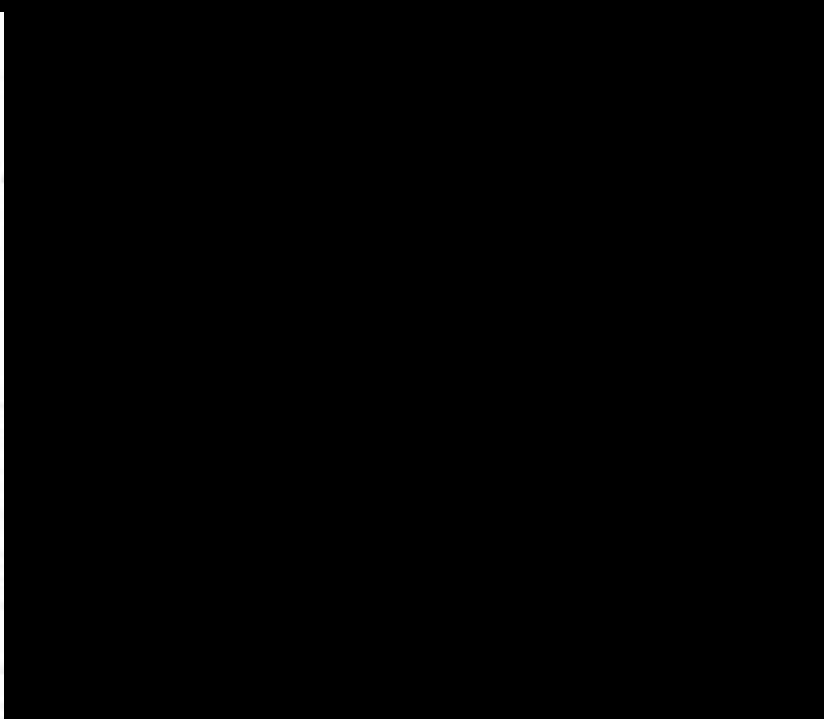
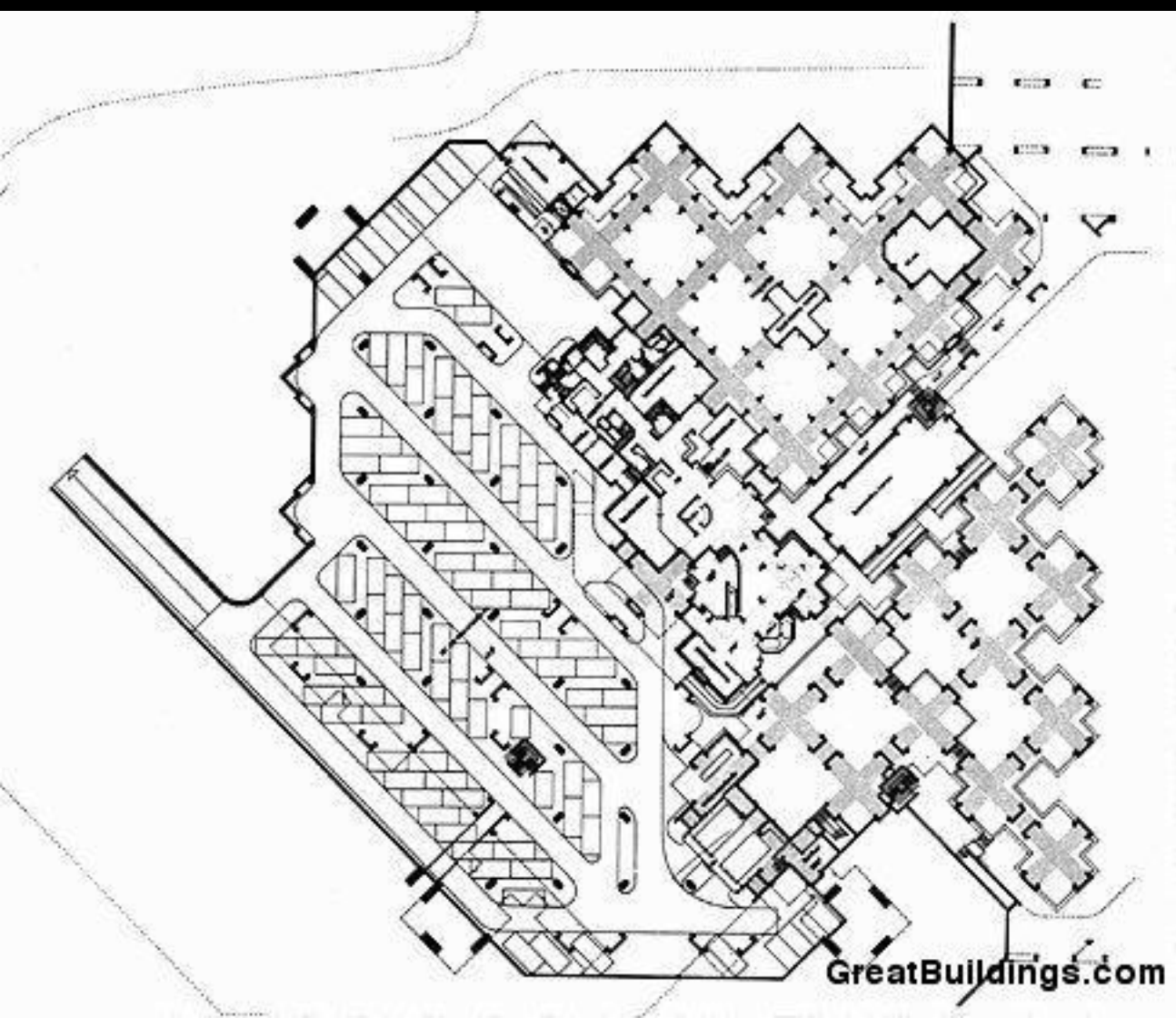

Herman Hertzberger, Centraal Beheer, Apeldoorn, 1968

laboratory sketches for an Arctic Town.

of the model of an Arctic Town.



keyword links: **layers** (2.3), **field/relationships** (2.6), **ground** (2.8), **orientation/path** (2.10)

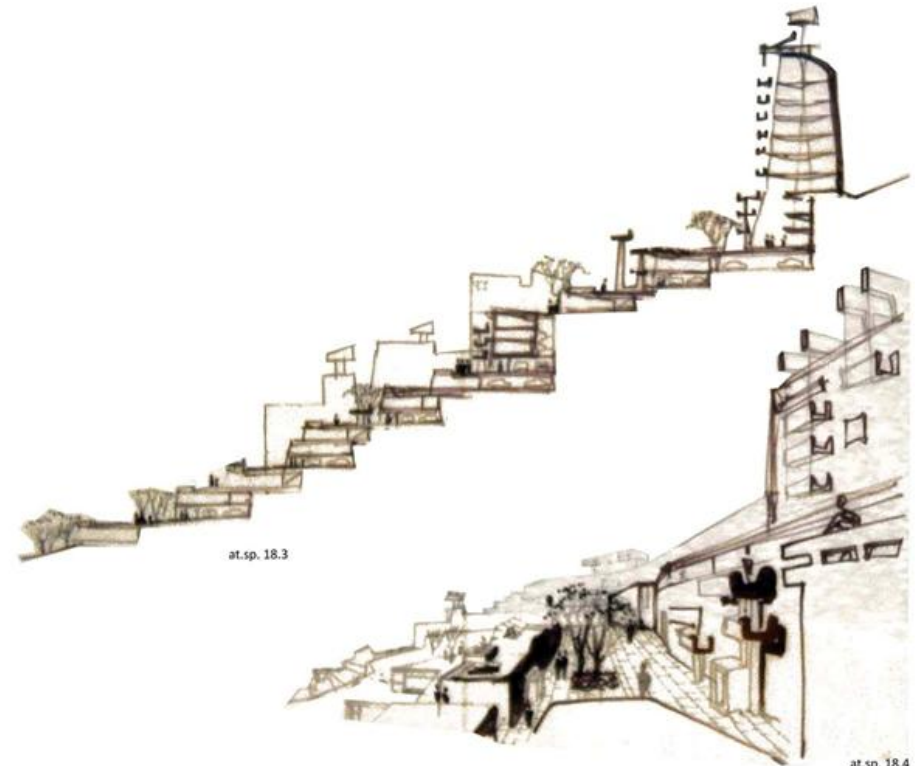

Sketches of sections, showing the intensity of *vertical layering* and use of the *ground*, to create *fields* of perceptual *orientation* through the feeling of elevation and *relationship* to the surroundings.

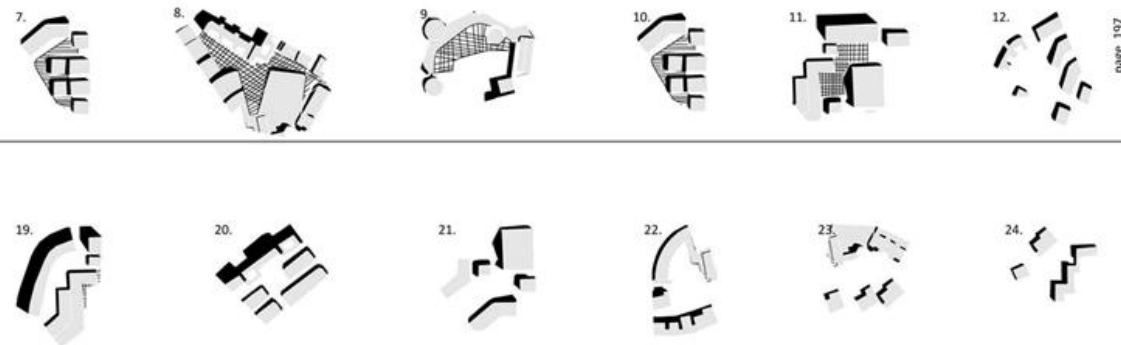

page 197

Ralph Erskine, Arctic Town, 1958



Fragment of the section,
student housing included.
Plan of the built volume.

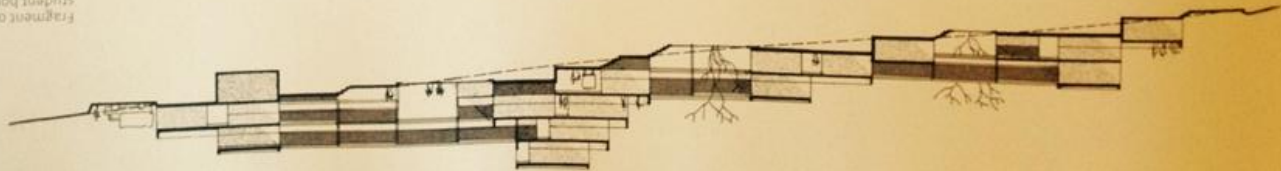

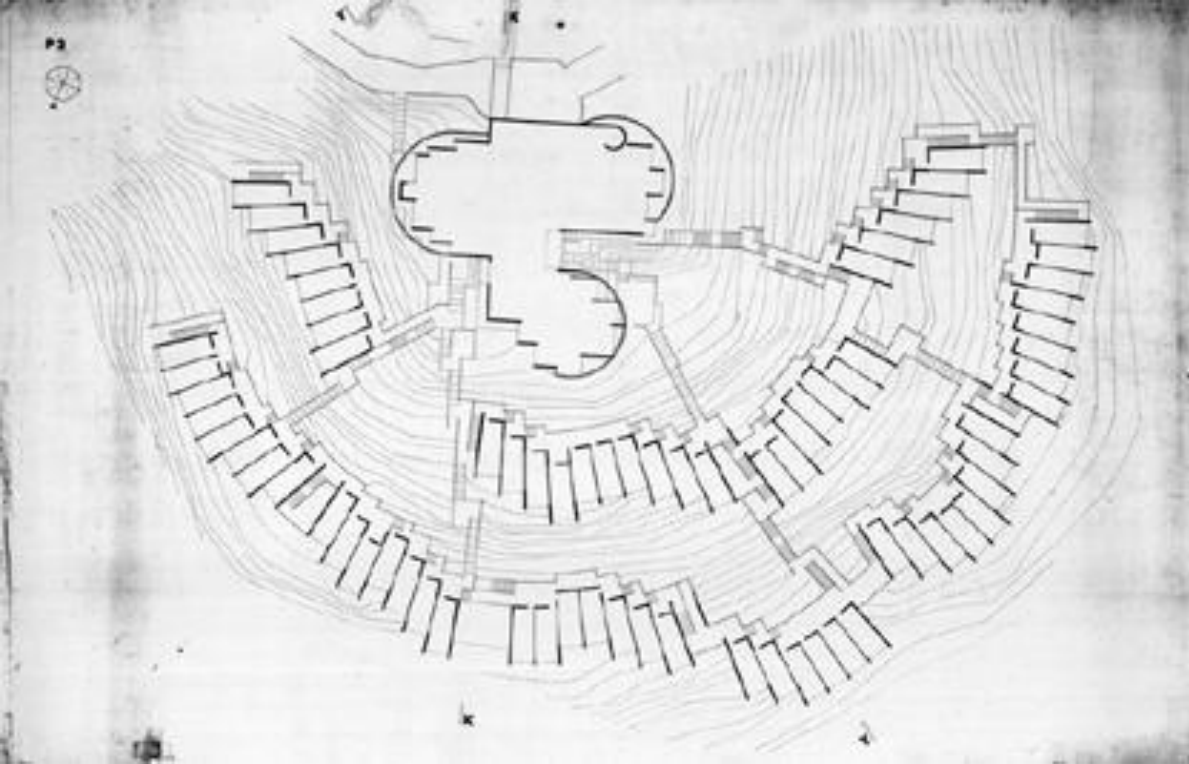

Giancarlo de Carlo, Collegio del Colle, Urbino, 1962



Plot Architects, PSY, 2006

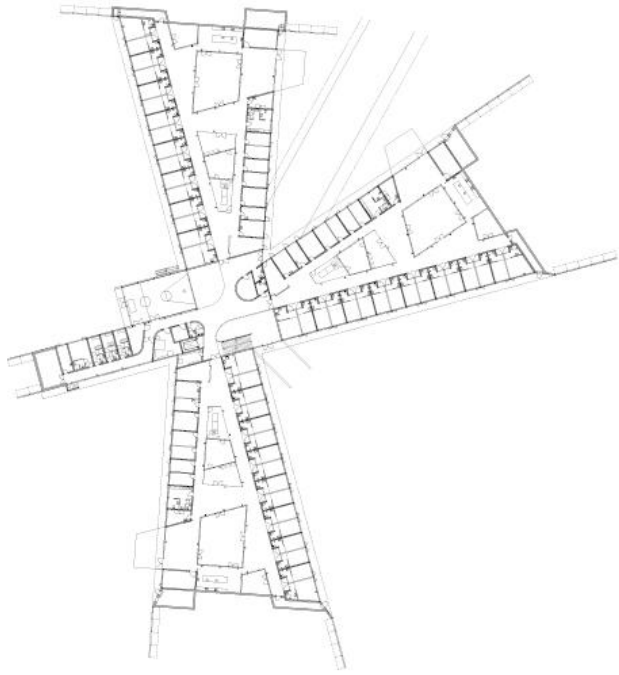

Plot Architects, PSY, 2006

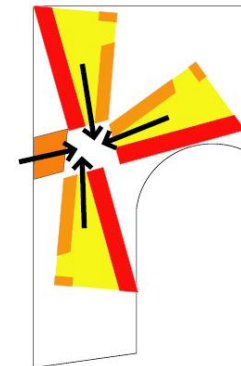

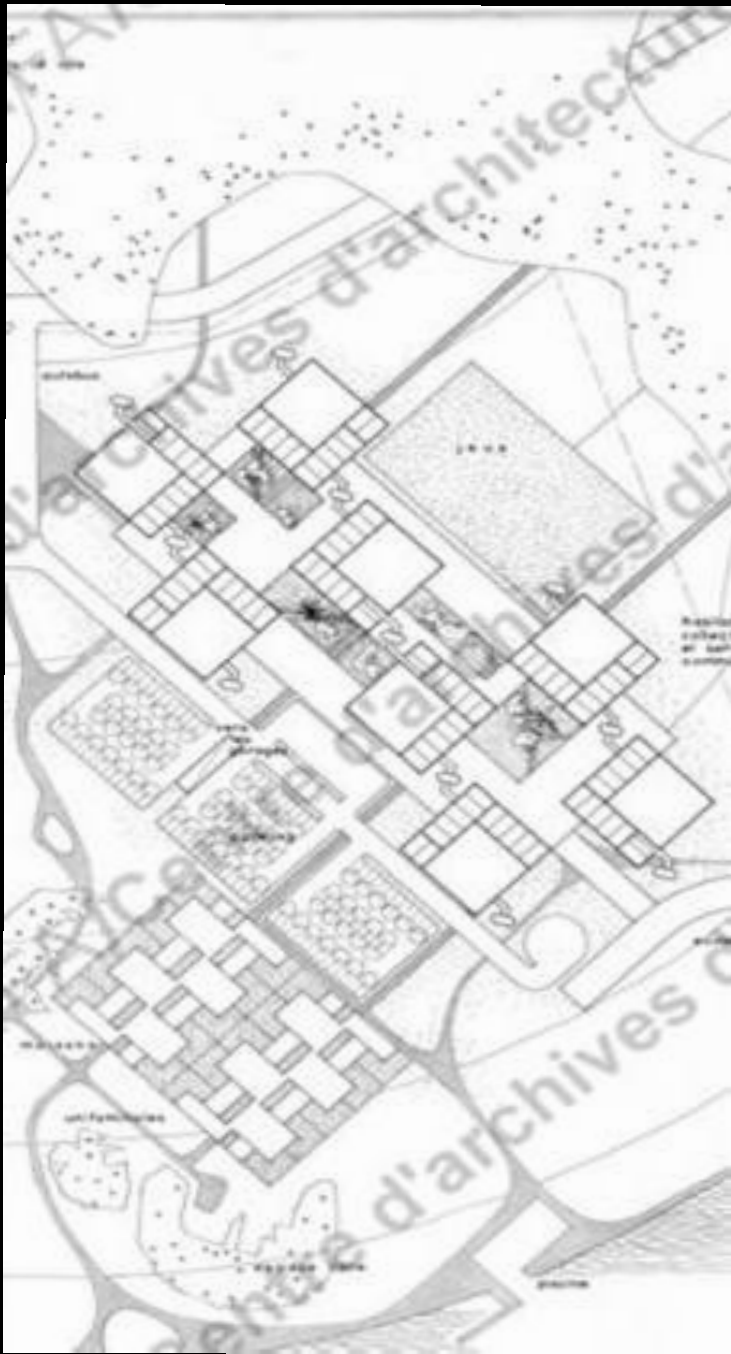

Atelier de Montrouge, Competition for 400 housings for CECA, 1959



Aterlier de Montrouge, Cap Camarat, 1961

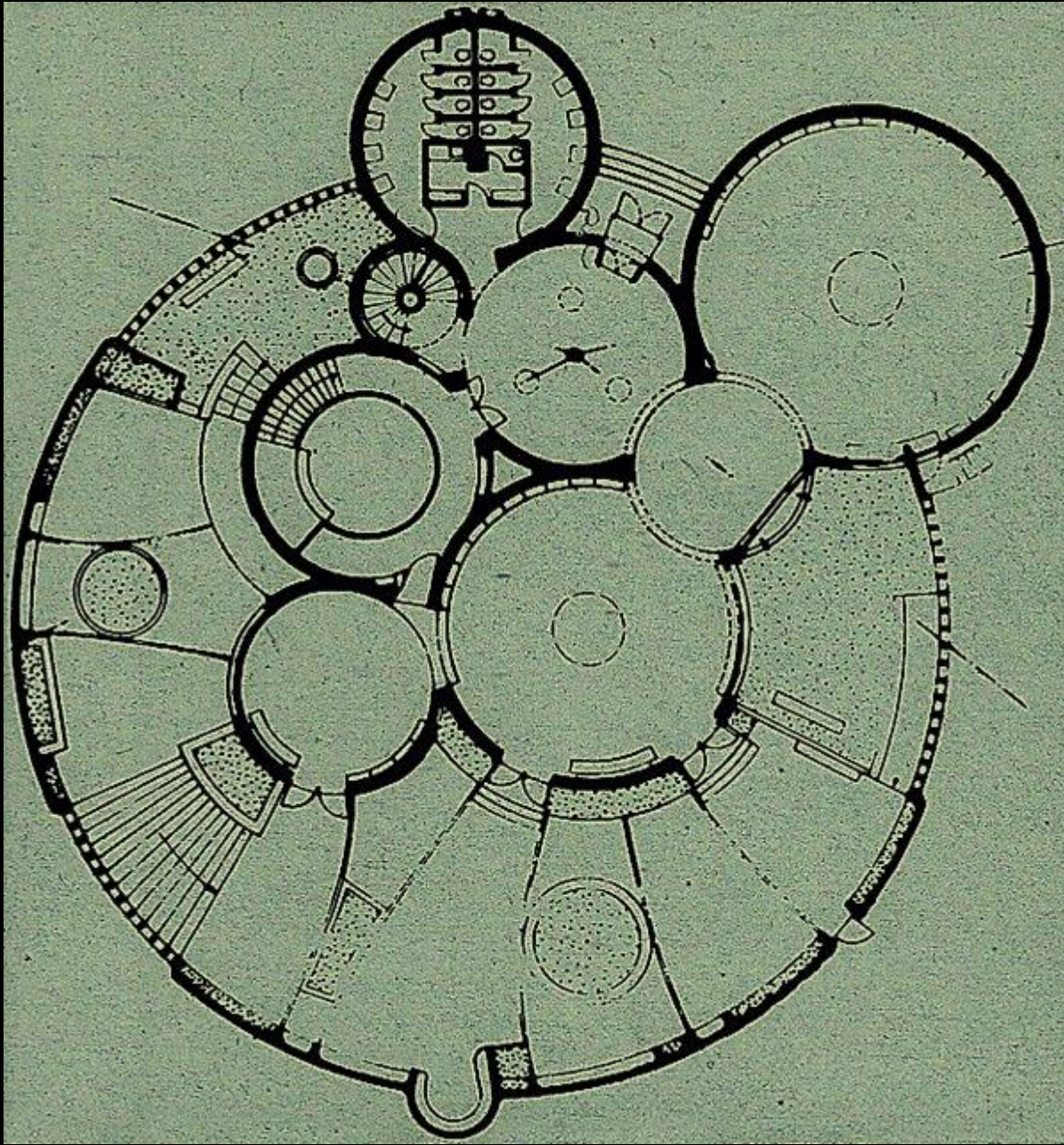

Aterlier de Montrouge, Library, Clamart, 1962

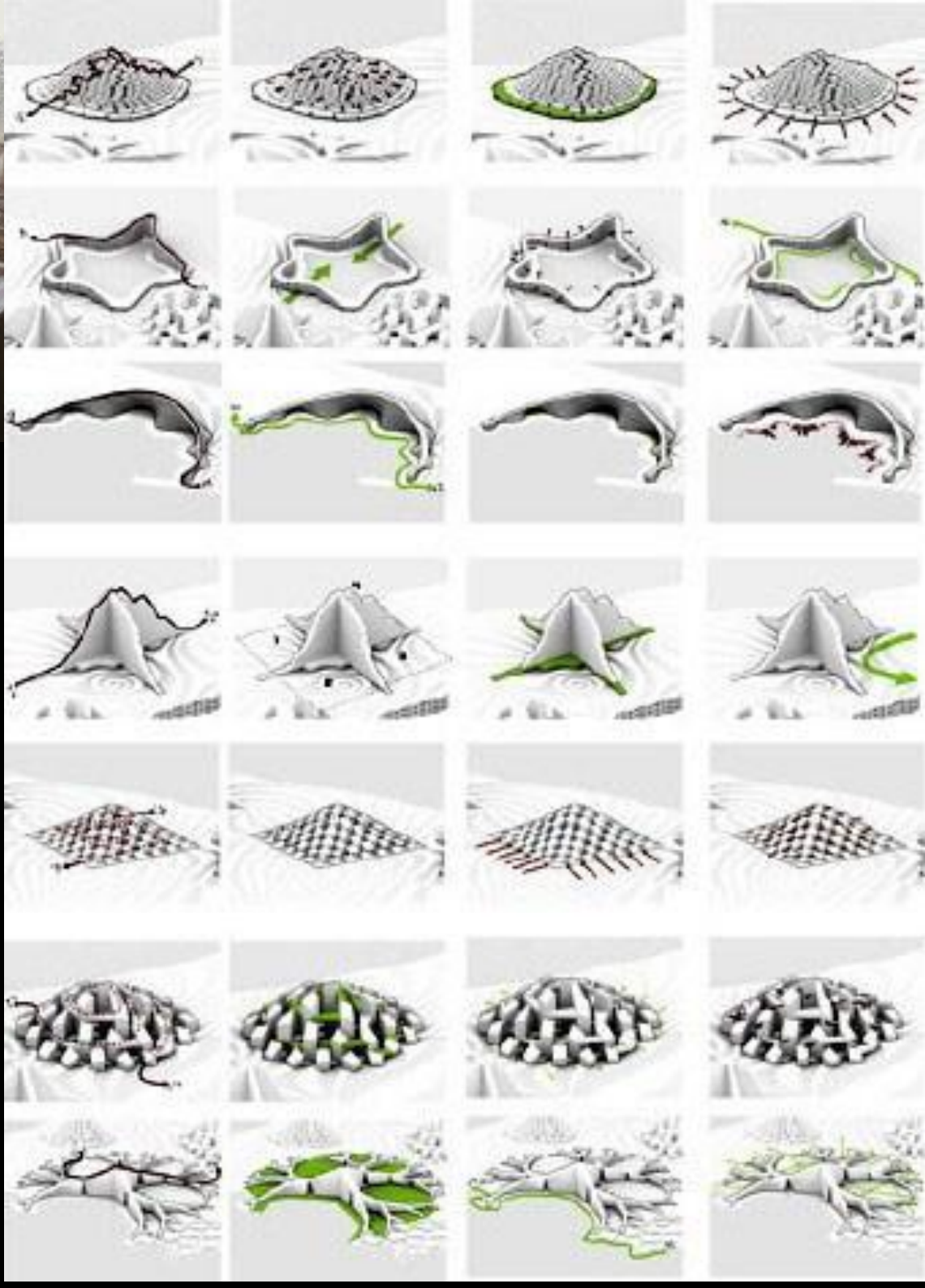

Big, Zira Island, 2007